

DIMENSIONS: mm

Size (Inch)	D	L	d	C	g	t	n-h	H
2	50.8	203.2	152.4	120.7	92.1	16.0	4- 19	152.40
2.5	63.5	215.9	177.8	139.7	104.8	17.5	4- 19	152.40
3	76.2	241.3	190.5	152.4	127.0	19.1	4- 19	158.75
4	101.6	292.1	228.6	190.5	157.1	23.9	8- 19	193.55
5	127.0	330.2	254.0	215.9	185.9	23.9	8- 22	193.55
6	152.4	355.6	279.4	241.3	215.9	25.4	8- 22	241.30
8	203.2	495.3	342.9	298.5	269.7	28.7	8- 22	292.10
10	254.0	622.3	406.4	362.0	323.9	30.2	12- 25	342.90
12	304.8	698.5	482.6	431.8	381.0	31.8	12- 25	381.00
14	336.6	787.4	533.4	476.3	412.8	35.1	12- 28	400.05
16	387.4	863.6	596.9	539.8	469.9	36.6	16- 28	438.15
18	438.2	977.9	635.0	577.9	533.4	39.9	16- 32	502.92
20	489.0	977.9	698.5	635.0	584.2	42.9	20- 32	541.02
24	590.6	1295.4	812.8	749.3	692.2	47.8	20- 35	675.13

MATERIALS:

ITEM	NAME	MATERIAL	QTY
1	BODY	ASTM A216 Gr WCB	1
2	BONNET	ASTM A216 Gr WCB	1
3	ARM	ASTM A216 Gr WCB	1
4	DISC	ASTM A216 Gr 410SS/F6A (CR13)*	1
5	GASKET	GRAPHITE	1
6	COVER BOLTS	A193 Gr B7	1 SET
7	COVER NUTS	A194 Gr 2H	1 SET
8	SEAT RING	A105 WITH 410SS (+PTFE/VITON*)	1
9	HINGE PIN	A479 Gr 410	1
10	PACKING	GRAPHITE	1
11	LEVER NUT	A194 Gr 2H	1
12	DISC NUT	A194 Gr 2H	1
13	LEVER	ROLLED STEEL/BAR	1
14	WASHER	STEEL	1
15	SPRING	INCONEL X750/OTHER	1
16	FUSIBLE LINK	UL/FM app (choice of temperature)	2
17	PIN	SS 18-8	2
18	PACKING BOX	CARBON STEEL	1
19	PACKING GLAND	410	1
20	PACKING NUT	CARBON STEEL	1
21	RETAINER	STEEL	1
22	EYE LIFTING BOLT	A193 GR B7 (250NB & OVER)	1

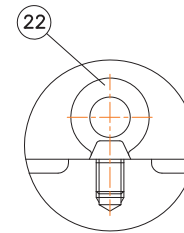

250NB (10") & OVER

Trim #8 Shown (example)

* Optional soft seat insert for tight shut-off

TECHNICAL :

MARKING	MSS-SP-25
FLANGE DIM.	ANSI B16.5
FACE TO FACE	ANSI B16.10
WALL THICKNESS	ANSI B16.34
DESIGNED	BS1868, ANSI B16.34
INSPECTION & TEST	API 598

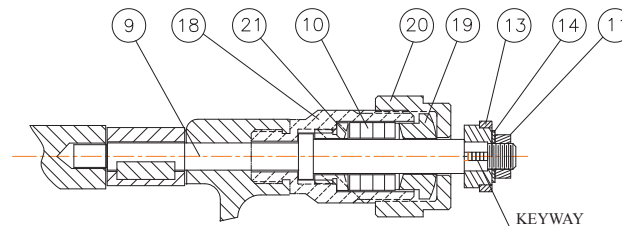

DETAIL A-A