

# BALL VALVES - MULTIWAY AND DEADMAN

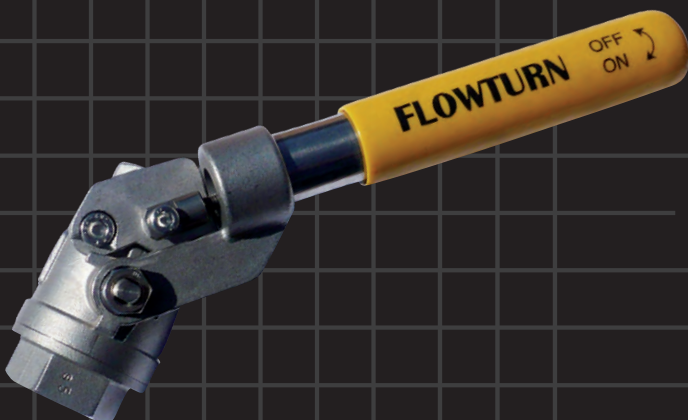
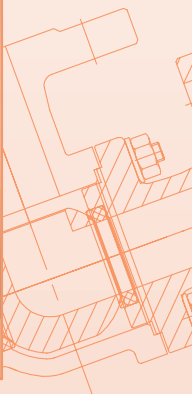
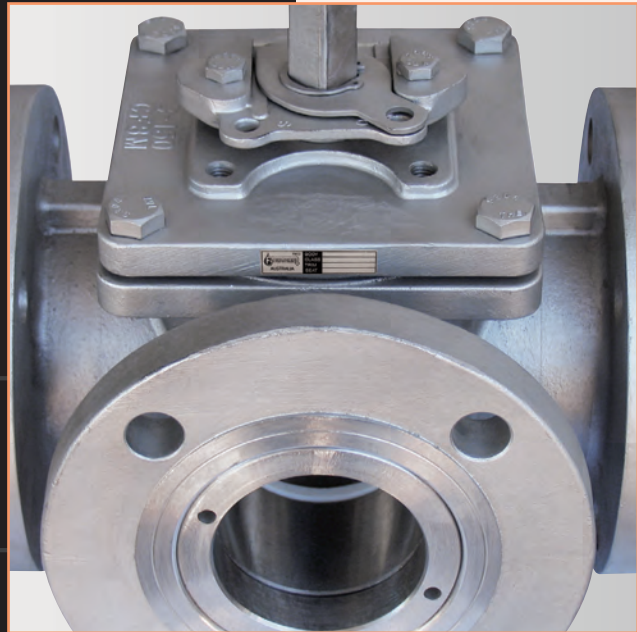
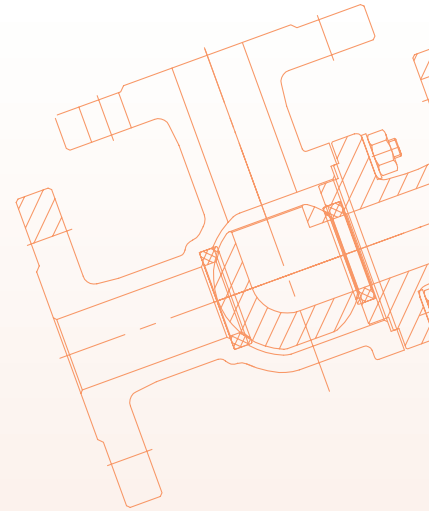
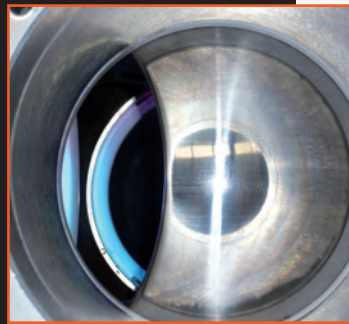

**AUSTRALIAN  
PIPELINE VALVE®**

[www.australianpipelinevalve.com.au](http://www.australianpipelinevalve.com.au)

# QUALITY VALVE MANUFACTURER

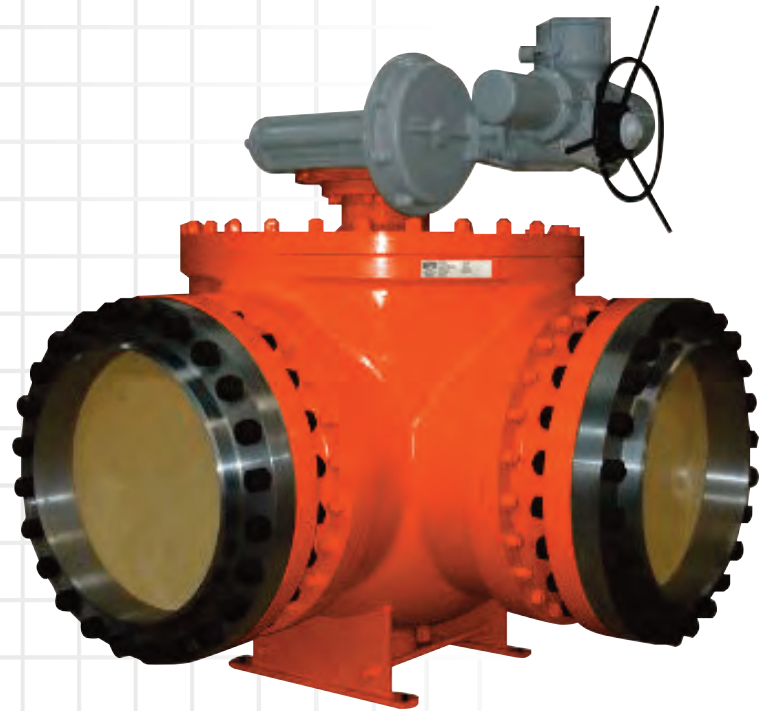

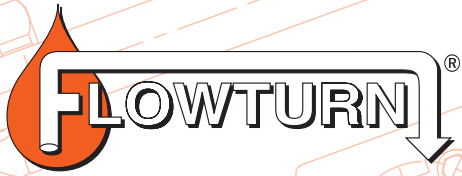

# Contents

Spring Return Deadman Handle KI Series	Page 4
Spring Return Deadman Handle 76-500 Series	Page 5-7
Spring Return Deadman Handle DH Series	Page 8
Fusible Link Emergency Shutdown Quarter Turn Valves	Page 9
Multiway Side Entry Unibody SL8141-IP	Page 10-13
Multiway Side Entry Unibody SL8142-FZ	Page 14-15
Multiway Side Entry 2 Piece SL9141	Page 16-17
Multiway Flanged Ball Valve BV-509	Page 18-19
Multiway Ball Valve BV-505	Page 20
Multiway Screwed End Stainless Steel Ball Valve 2058	Page 21-22
Multiway Screwed End Brass Diverting Valve	Page 23
Hygienic Quarter Turn Valves	Page 24

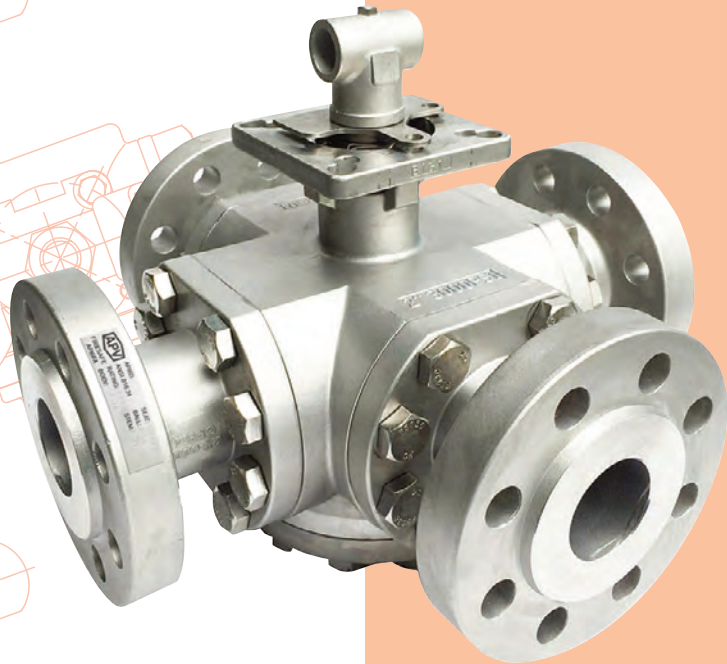

AUSTRALIAN PIPELINE VALVE®  
70-78 Stanbel Road Salisbury Plain South Australia 5109  
Telephone +61 (0)8 8285 0033 Fax +61 (0)8 8285 0044  
email: [admin@australianpipelinevalve.com.au](mailto:admin@australianpipelinevalve.com.au)

# Spring Return Deadman Handle for Quarter Turn Valves KI Series



Spring Return Handle provides unassisted opening or closing of manually operated quarter turn valves. The Spring Return Handle, driven by a powerful, completely enclosed torsion spring, automatically returns the valve to the desired fully-open or fully-closed position when released. Automatic valve repositioning is a convenience and safety feature for filling, sampling, or dispensing applications. The automatic repositioning is ideal as a safety feature in manual emergency conditions. It is ruggedly constructed to meet the demanding requirements of rapid and repetitive operations. Unless specified otherwise, valve/handle assemblies will be furnished for spring-to-close operation.

## FEATURES OF ROTARY STYLE SPRING RETURN OPERATOR

- Positive quick acting operation for ball, plug, or butterfly valve
- Strong, durable torsion spring mechanism
- Rugged metal construction
- Enclosed clock-type 90 degree spring
- Weatherproof sealed spring housing
- Tough corrosion resistant epoxy paint
- Reliable low stress range springs are available in clockwise or counter-clockwise action
- Valve cannot be left in wrong position

## OPTIONAL EQUIPMENT

- Limit switches for remote indication of valve position. Unless otherwise specified, SPDT limit switches will be provided to indicate open and closed positions.
- A locking device to permit padlocking the handle in either the open or closed position is available.

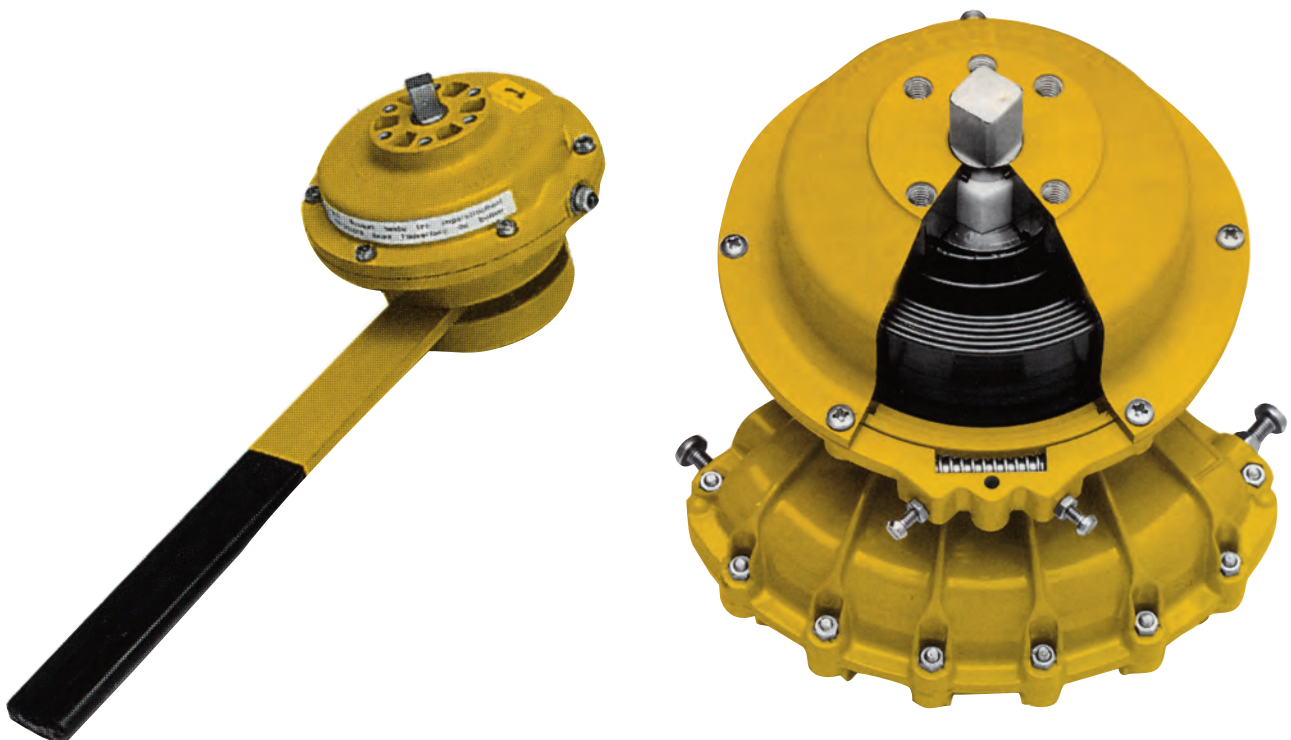

Spring Housing cut away to show detail of Spring  
& Worm Gear

# Deadman Spring Return Ball Valve (Full Port) S-76-500 Series



## MODEL T-SR2

### FEATURES

- Full Port
- Spring Return Handle
- Investment Cast Body
- Blow Out Proof Stem/ Floating Ball
- Adjustable Packing Gland
- 150 PSI Saturated Steam
- Working Pressure 13789 kPa (2000PSI) WOG
- Threads Conform to ANSI B1.20.1, BS21, DIN259/2999
- Also available in 3 piece body
- Also available in 3000 PSI, 3700 PSI
- Available in BSP or NPT ends
- Available in Bronze, SS & Carbon Steel



### MATERIALS LIST

No.	Part Name	Material	
1	Body	A351-CF8M	A216-WCB
2	End Cap	A351-CF8M	A216-WCB
3	Ball	ASTM A351 Gr. CF8M	
4	Ball Seat	RPTFE	
5	Body Seal	PTFE	
6	Stem	A276 TYPE 316	
7	Thrust Washer	RPTFE	
8	Stem Packing	RPTFE	
9	Gland Nut	SUS 304	
10	Stem Washer	SUS 304	
11	Stem Nut	SUS 304	
12	Handle	A351 - CF8 & SS 304	
13	Handle Hex	SUS 304	
14	Handle Flange	A351 - CF8	
15	Handle Sleeve	VINYL	
16	Handle Bolt	SUS 304	
17	Spring	55CrSi	

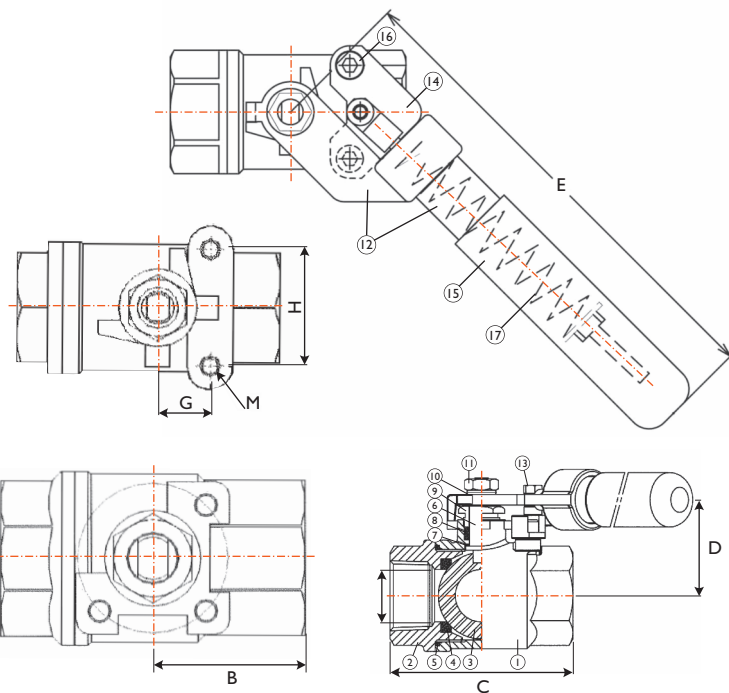

TEST PRESSURE	
Shell Test (Water)	3000PSI
Seat Test (Water)	2200PSI
Seat Test (Air)	80PSI

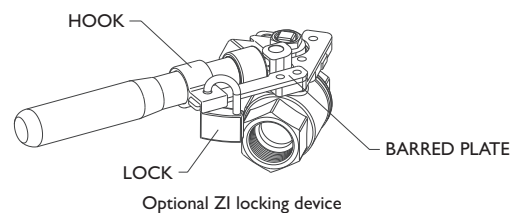

### DIMENSIONS

Size		A		B		C		D		E	
in	mm	in	mm	in	mm	in	mm	in	mm	in	mm
¼"	8	0.377	9.6	1.122	28.5	2.244	57	1.161	29.5	7.244	184
⅜"	10	0.492	12.5	1.122	28.5	2.244	57	1.161	29.5	7.244	184
½"	15	0.59	15	1.301	33.05	2.602	66.1	1.287	32.7	7.244	184
¾"	20	0.787	20	1.488	37.8	2.976	75.6	1.44	36.6	7.244	184
1"	25	0.984	25	1.716	43.6	3.433	87.2	1.779	45.2	9.094	231
1¼"	32	1.259	32	1.909	48.5	3.818	97	2.106	53.5	9.094	231
1½"	40	1.496	38	2.283	56.6	4.456	113.2	2.342	59.5	9.094	231*
2"	50	1.968	50	2.637	67	5.275	134	2.807	71.3	12.716	323

\* Next size lever up required depending on service/pressure.

### PRESSURE TEMPERATURE RATING

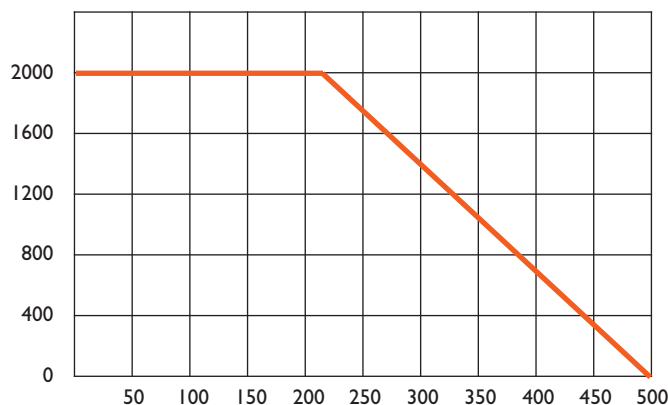

# Deadman Spring Return Ball Valve (Standard Port) 76-500 Series



## FEATURES

- Full Port to 15NB (1/2"), standard port 20NB~50NB (3/4" - 2")
- Spring Return Handle
- Investment Cast Body
- Blow Out Proof Stem/ Floating Ball
- Adjustable Packing Gland
- Working Pressure 13789 kPa 2000 PSI WOG
- 150 PSI\* Saturated Steam
- Threads Conform to ANSI B1.20.1, BS21, DIN259/2999
- Also available in 3 piece body
- Also available in 3000 PSI, 3700 PSI
- Available in BSP or NPT ends

\*High Temperature & pressure seats also available



## MATERIALS LIST

No.	Part Name	Material	
1	Body	A351-CF8M	A216-WCB
2	Cap	A351-CF8M	A216-WCB
3	Ball	A351-CF8M	A351-CF8
4	Ball Seat	RPTFE	
5	Joint Gasket	PTFE	
6	Thrust Washer	RPTFE	
7	Stem	AISI 316	
8	Stem Packing	RPTFE	
9	Gland Nut	A194 Gr.8	
10	Stem Nut	A194 Gr.8	
11	Spring Handle	AISI 304 / A351-CF8	
12	Handle Cover	Vinyl	
13	Spring	55CrSi	

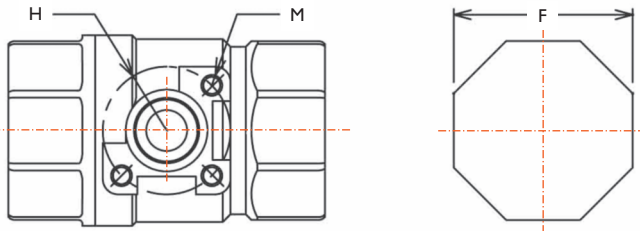

SIZE 1-1/4" TO 2"

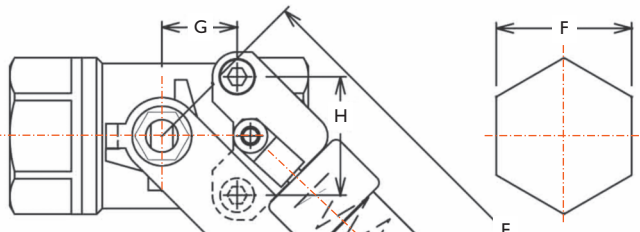

SIZE 1/4" TO 1"

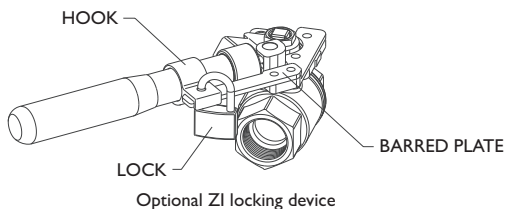
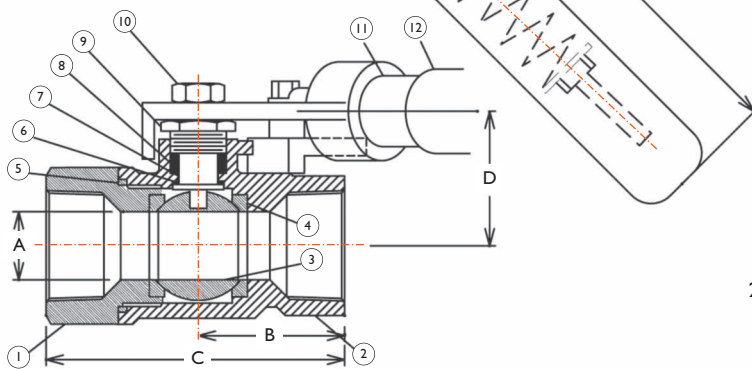

TEST PRESSURE	
Shell Test (Water)	3000PSI
Seat Test (Water)	2200PSI
Seat Test (Air)	80PSI

## DIMENSIONS

Size	8	10	15	20	25	32	40	50
	1/4"	3/8"	1/2"	3/4"	1"	1 1/4"	1 1/2"	2"
A	11	12.5	12.5	15	20	25	32	38
B	27.5	27.5	28.4	37.5	43	46	51.5	62
C	58.5	58.5	65	77	86.5	99	103	124
D	30	30	30	37.3	39.5	53.5	57.7	64.5
E	178	178	178	178	178	275	275	275
F	24	24	27	32	41	50	60	70
G	12.7			22.1				
H	28.5			34.8		Ø50		
I	M6*1					M8*1.25		

## PRESSURE TEMPERATURE RATING

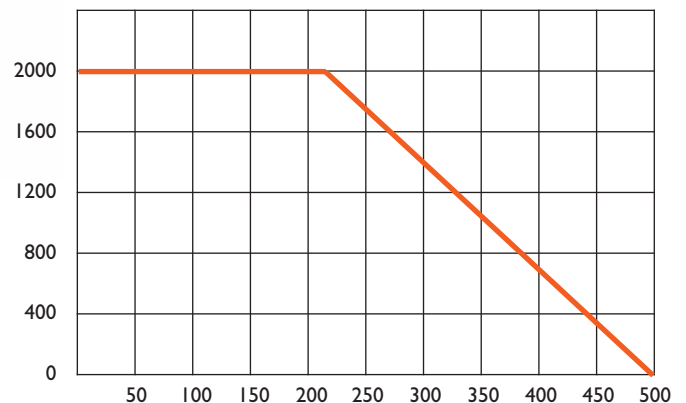

# Spring Return Deadman Handle for Quarter Turn Valves 76 Series (Kits)



71-503-00 ~ 71-509-00



S71-510-00-ZI  
Double lever type over 100NM



Can be fitted IP, 2P & 3P

## FEATURES

- All components of lever are stainless steel
- Operating torque should be sized according to valve torque, media, pressure and safety.
- Can be fitted on IP, 2P, 3P valve
- Available in ISO F03 to F06
- 55CrSi Spring Material

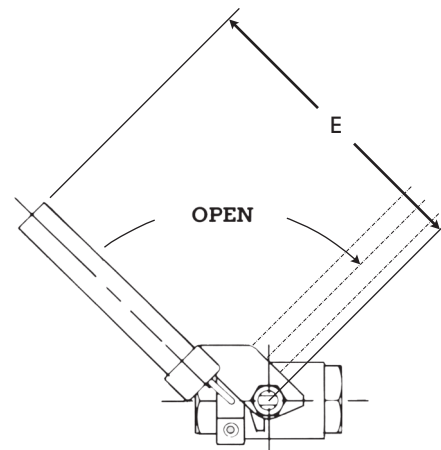
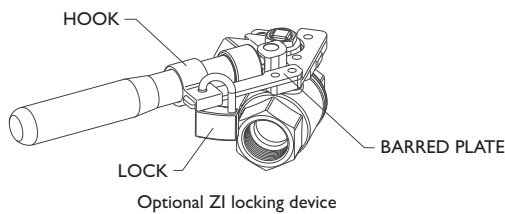

'Deadman' Spring Return Kit Only		76 Series		S76 Series	
76 Series Kit Part No.	S76 Series Kit Part No.	E mm (inch)	Torque	E mm (inch)	Torque
71-503-00	S71-503-00	178 (7")	15Nm	184 (7.24")	15Nm
71-503-00	S71-503-00	178 (7")	15Nm	184 (7.24")	15Nm
71-503-00	S71-503-00	178 (7")	15Nm	184 (7.24")	15Nm
71-505-00	S71-505-00	178 (7")	15Nm	184 (7.24")	15Nm
71-505-00	S71-505-00	178 (7")	15Nm	231 (9.094")	22Nm
71-508-00	S71-508-00	275 (10.82")	22Nm	231 (9.094")	22Nm
71-508-00	S71-508-00	275 (10.82")	22Nm	231 (9.094")	22Nm
71-508-00	S71-509-00 - KI	275 (10.82")	22Nm	323 (12.716")	48Nm
	S71-510-00 - ZI			500 (19.685")	100Nm

Also up to 300NM available. Refer to drawing.

# Spring Return Deadman Handle for Quarter Turn Valves DH Series

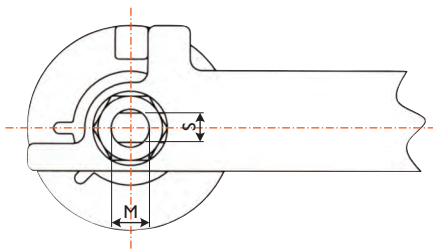

## FEATURES

- Size : DN15 ~ DN50 (1/2" - 2")

Designed to mount upon ISO 5211 direct mounting pad

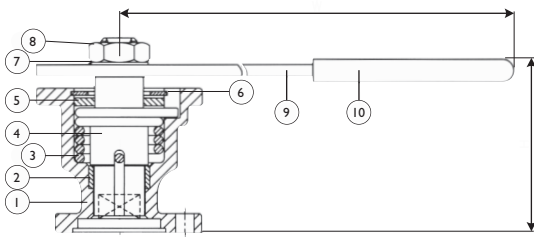

Item	Parts	Material
1	Body	ASTM A351-CF8M
2	Packing	PTFE
3	Spring	65Mn
4	Stem	AISI 304
5	Flat Washer	
6	Circlip for Shaft	
7	Spring Washer	
8	Nut	
9	Handle	PVC
10	Handle Sleeve	

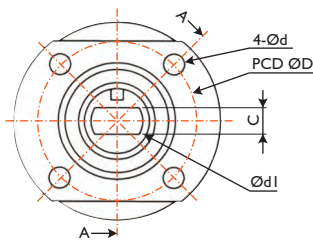

## DIMENSIONS (MM)

DN	H	W	S	C	d	dI	DI	M
15 - 20	56	195	8	5.7	6	13	36	7/16" - 20 UNF
25 - 32	56.5	195	8	7.5	6	15	42	7/16" - 20 UNF
40 - 50	70.5	245	9.5	8.6	7	20	50	5/8" - 18 UNF

DN	H	W	S	C	d	dI	DI	M
1/2" - 3/4"	2.2	7.68	0.31	0.22	0.24	0.51	1.42	7/16" - 20 UNF
1" - 1 1/4"	2.22	7.68	0.31	0.3	0.24	0.59	1.65	7/16" - 20 UNF
1 1/2" - 2"	2.78	9.65	0.37	0.34	0.28	0.79	1.97	5/8" - 18 UNF



# Fusible Link Emergency Shutdown Quarter Turn Valves



Valves designed with fire control in mind are crucial to any piping system carrying flammable fluids or gases. Our spring actuated assemblies are designed to fail-close when a fire breaks out, halting the flow which may be adding to or compounding the fire intensity. Valves on the deluge system can be activated to fail-open when heat is sensed, immediately flooding the area with water.

Our fusible link assembly provides the ideal fire protection solution. Designed to melt when environmental heat reaches a predetermined setting, the fusible link separates and allows the spring to drive the valve into the fail-open or fail-closed position. The fire sensitive unit mounts directly onto a quarter turn valve and can be manually operated when required. Unless specified otherwise, spring assemblies will be furnished for spring-to-close operation.

The spring module is completely enclosed for maximum safety and the fusible link is mounted externally for environmental sensitivity. The spring actuated assemblies can be retrofitted to many existing valves and are fully field-adjustable. Optional limit switches are available for remote indication of open or closed positions. Typical applications for these units can be found in paint plants, chemical, or hydrocarbon processing facilities.

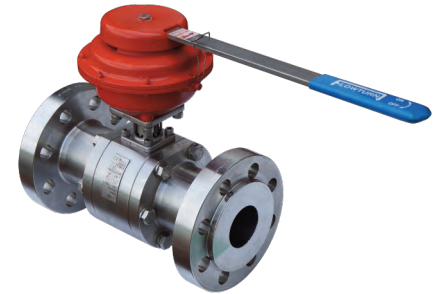

**Shuts down in event of fire. Fusible link for quick quarter-turn operation in fail-safe valve positioning (fail-closed positioning).**



**A temperature sensitive valve actuator with a self-contained energy source, for automatic valve operation in the event of a fire (fail-open positioning).**

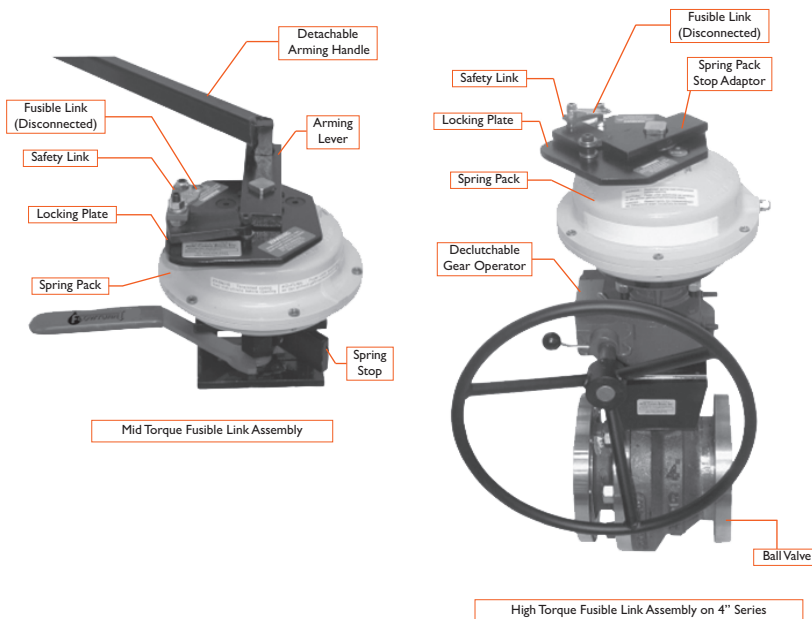

# Multiway Side Entry Unibody Ball Valve

## 8000 Series



PORT TYPE	1	2	3	4
L (3 Seat)				
T (4 Seat)				
Double L (4 way)				

### MODEL SL8141-IP (TL/WF)

Flanged Ends 3-Way Ball Valves

Cast iron FC20, S.S 304 & 316. Full port, Cast body.

Size: 40NB ~ 250NB (1½" ~ 10") 150# & 300#

Mounting: To ANSI B16.5, ISO 5211

- Individually tested in factory for zero leakage
- Adjustable Gland packing
- Three/Four-seat design for positive shut off in all directions regardless of entry point
- Media trapped in valve cavity is substantially reduced with 4 seats
- 90 Degree turn operation. (ISO mounting on Request)
- Trunnion supported ball for lower torque and longer service life
- Transflow style

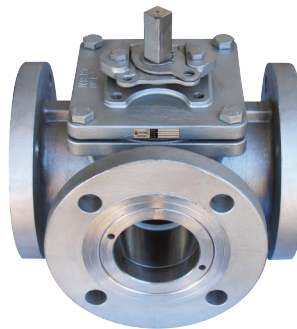

3 Seat Design (4 seat for T-Port) multi-directional shut off can be used in any direction i.e. a "T" port can be utilised as an L port by turning 180 degrees.

Flow can be directed into any inlet as these valves have 3 seats. "Y" type (piggable) also available.

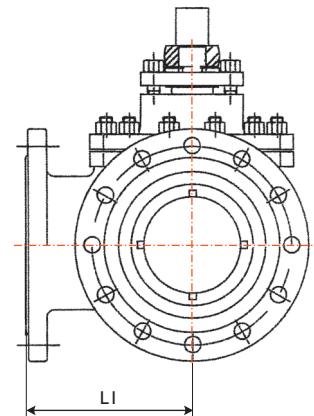
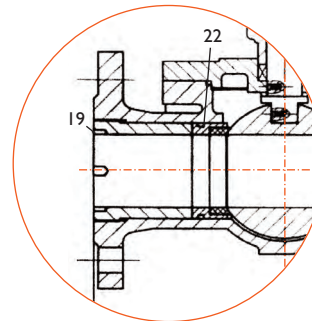
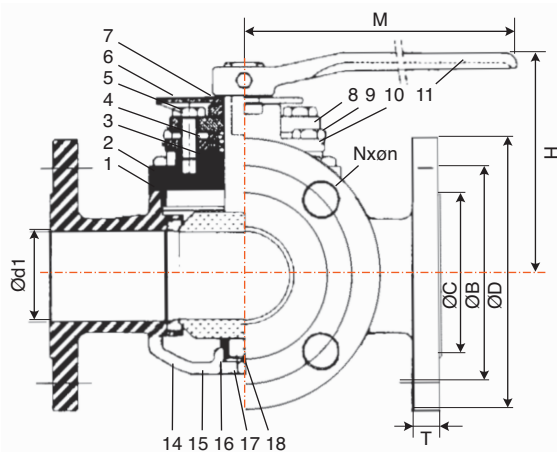

Now also available:-  
Firesafe Design c/w antistatic device, graphite stem packing, graphite/spiral body joint gaskets

Inserts unscrew for easier removal of seats and ball through bonnet for servicing.

No	Part Name	CF8M S/S	CF8 S/S	WCB	Cast Iron	Qty
1	Gasket	PTFE	PTFE	PTE	PTFE	1
2	Cover	ASTM A351 CF8M	ASTM A351 CF8	ASTM A216 WCB	FC-20	1
3	Stem Packing (#2)	PTFE	PTFE	PTFE	PTFE	1
4	Gland	SUS304	SUS304	SUS304	Cast Iron	1
5	Bolt	B8	B8	B7	S45C	2
6	Stopper	SUS304	SUS304	Carbon Steel	Carbon Steel	1
7	C Retainer Ring					1
8	Bonnet Cap	ASTM A351 Gr. CF8M	ASTM A351 CF8	ASTM A216 WCB	FC-20	1
9	Bolt	B8	B8	B7	S45C	4
10	Bracket	CF8	CF8	ASTM A216 WCB	FC-20	1
11	Handle	Ductile Iron	Ductile Iron	Ductile Iron	PTFE	3
14	Ball Seat	RPTFE	RPTFE/PTFE	RPTFE/PTFE	RPTFE/PTFE	3
15	Body	ASTM A351 Gr. CF8M	ASTM A351 CF8	ASTM A216 WCB	FC-20	1
16	Bushing	50/50 SS/PTFE Filled	50/50 SS/PTFE	50/50 SS/PTFE	50/50 SS/PTFE	1
17	Ball & Stem	ASTM A351 Gr. CF8M	ASTM A351 CF8M	ASTM A351 CF8M	ASTM A351 CF8	1
18	Antistatic (#2)	SUS304	SUS304	SUS304	SUS3014	1
19	Seat Retainer	ASTM A351 CF8M	ASTM A351 CF8	ASTM A216 WCB	Cast Iron	3
21	Bolt	B8	B8	B7	S45C	#
22	O-Ring	Viton	Viton	Viton	Viton	

# Model SL8141-1P

## ANSI 125# & 150# ANSI B16.5 DIMENSION (mm)

Size	øB	øC	øD	ød1	H	L1	L2	M	N	øn	T	Weight Kg
1"	79.4	50.9	108	25	100	180	90					
1½"	98.5	73	127	39	115	190/213/220	95/107/110	385	4	15	14.3	20
2"	120.6	92	152	51	148.5	216/220/240	108/110/120	385	4	19	15.9	23
2½"	139.7	105	178	63	142	249/260	125/130	340				24
3"	152.4	127	191	76	163.5	255/241/280	126/140/136	385	4	19	19.1	29
4"	190.5	157	229	102	199	330/370/320	160/165/216	500	4	19	23.9	45
5"	254	186	254	125	220	410	210	340				46
6"	241.3	216	279	152	262.5	432	215/305	900	8	22	25.4	105
8"	298.5	270	343	202	284	540	270	900	8	22	28.5	
10"	362	324	406	252	360	750	375	1000	12	25	30.2	

Larger sizes up to 600NB refer drawings SL8141-OVK Series.

## ANSI 300# ANSI B16.5 DIMENSION (mm)

Size	øB	øC	øD	ød1	H	L1	L2	M	N	øn	T	Weight Kg
1"	88.9	51	124		100							
1½"	114.3	73	156	39	115			385	4	15	14.3	
2"	127.0	92	165	51	148.5			385	4	19	15.9	
2½"	149.2	105	191	63	142			340				
3"	168.3	127	210	76	163.5	280	140	385	4	19	19.1	
4"	200.0	157	254	102	199			500	4	19	23.9	

Larger sizes up to 600NB refer drawings SL8141-OVK Series.

## PRESSURE/TEMPERATURE RATING (RPTFE) 150# ANSI WCB CF8 & CF8M BODY

Temperature	to 80NB	100NB - 150NB	200NB
Up to 60°C	1963kpa (285PSI)	1963kpa (285PSI)	1963kpa (285PSI)
Up to 80°C	1929kpa (280PSI)	1722kpa (250PSI)	1378kpa (200PSI)
Up to 130°C	1722kpa (250PSI)	1515kpa (220PSI)	1033kpa (150PSI)
Up to 140°C	1580kpa (230PSI)	1378kpa (200PSI)	861kpa (125PSI)
Up to 180°C	551kpa (80PSI)	482kpa (70PSI)	344kpa (50PSI)
Up to 200°C	172kpa (25PSI)	137kpa (20PSI)	69kpa (10PSI)
Up to 210°C	137kpa (20PSI)	34kpa (5PSI)	
Up to 220°C	68kpa (10PSI)		

Refer chart for 300LB

Carbon filled teflon will do higher pressures in the high temperature range

Ratings shown above and below apply when temperature on all ports is equal and applies to the highest pressure rating on all of the ports.

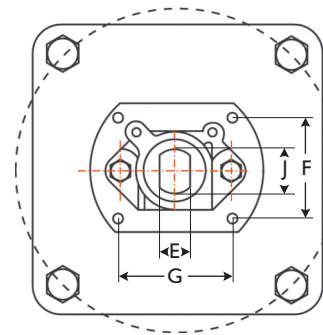
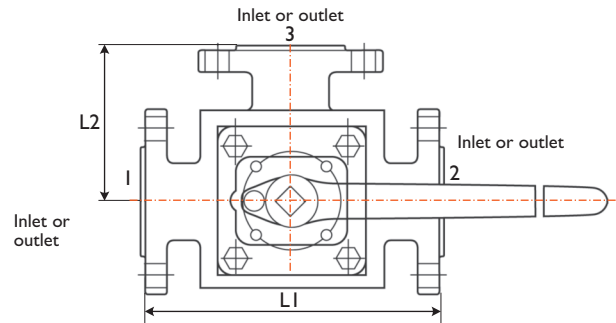

## PRESSURE/TEMPERATURE (up to 150NB)

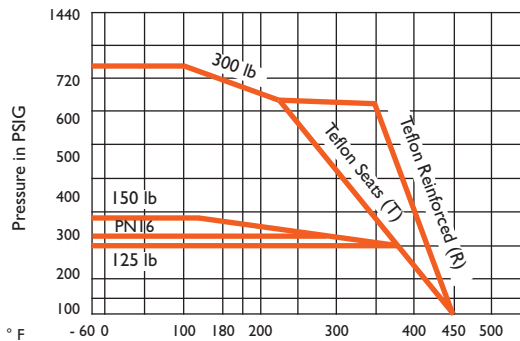

This chart applies up to 150NB only.

## MOUNTING PAD DIMENSIONS (MM)

Size	1½"	2"	2½"	3"	4"
E					
J					
F					
G					

As per customers optional requirement, refer drawing. (ISO 5211 Mounting Pad available)

# Model SL8141-1P

Size	150#	
	ΔP 280PSI	
	T Port	L Port
2"	96NM	80NM
2½"	156NM	150NM
3"	200NM	180NM
4"	348NM	365NM
6"	700NM	690NM
8"	2200NM	2060NM

## BREAK TORQUE OUTPUT BASED ON CLEAN FLUIDS

15% safety factor is included. Torque shown is at 285 PSI differential.  
Running torque averages 1/3 of break torque + 20% safety  
For dry service or infrequent use add 40% (-10% oil)

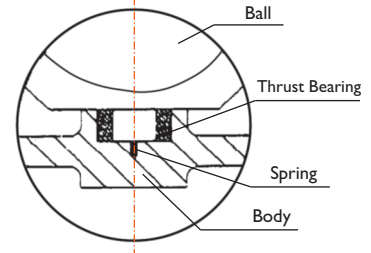

Trunnion Ball Support

## EFFECTIVE STEM SEALING

- "Corner Sealing" the compression of low friction TFE box rings, eliminates stem leakage by avoiding straight-line leakage paths.
- Stem seal adjustment, if ever required, is done by simply tightening bonnet screws or bolts.

## BI-DIRECTIONAL FLOW

- Allows flow into the end ports and out of the common side port for mixing applications, or into the side port and out of either end port for diverting applications.

150 Class CV/Litre/Minute at 1 PSI pressure drop L Port		150 Class CV (US gallons/minute)	
		* T Port	L Port
40NB	189	200	50
50NB	529	400	140
65NB	604	650	160
80NB	982	1000	260
100NB	1625	2000	40
150NB	3326		880
200NB	5670		1500
250NB	8694		2300
300NB			

\*With all three ports open

## FLOW PATTERNS FOR 3 WAY VALVES

All T-PORT Flow Patterns can be changed in-the field without disassembling valve

### L-PORT: 90°

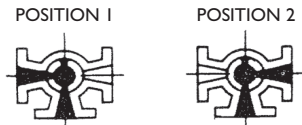

FLOW PLAN A

### T-PORT: 90°

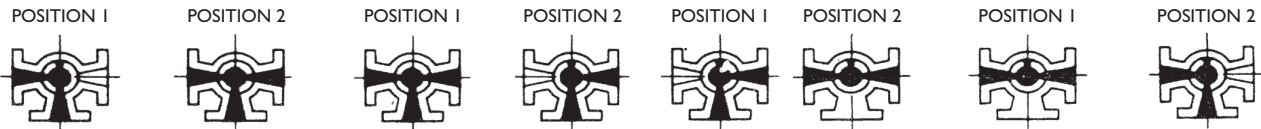

FLOW PLAN D

FLOW PLAN E

FLOW PLAN F

FLOW PLAN G

### T-PORT: 180°



FLOW PLAN H

FLOW PLAN I

### T-PORT: 180°



FLOW PLAN J

FLOW PLAN K

# 4-Way Double L Port Ball Valves SL8141-KI Series

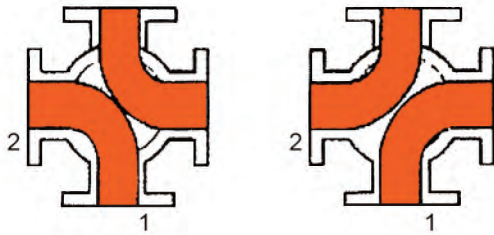

**MATERIAL:** CF8/CF8M, C.I. FC-20  
**FLANGED:** ANSI 150LB OR JIS 10K

**BODY:** Cast Iron (FC-20)  
SUS 304 (CF8), SUS 316 (CF8M)  
**STEM:** SUS 304, SUS 316  
**BALL:** SUS 304, SUS 316  
**SEATS:** PTFE, REINFORCED PTFE

TEST PRESSURE	
150LB-82kgf/cm <sup>2</sup> (WATER)	
6kgf/cm <sup>2</sup> (AIR)	

## PRESSURE/TEMPERATURE RATING (RPTFE) 150# ANSI WCB CF8 & CF8M BODY

Temperature	to 80NB	100NB - 150NB	200NB
Up to 60°C	1963kpa (285PSI)	1963kpa (285PSI)	1963kpa (285PSI)
Up to 80°C	1929kpa (280PSI)	1722kpa (250PSI)	1378kpa (200PSI)
Up to 130°C	1722kpa (250PSI)	1515kpa (220PSI)	1033kpa (150PSI)
Up to 140°C	1580kpa (230PSI)	1378kpa (200PSI)	861kpa (125PSI)
Up to 180°C	551kpa (80PSI)	482kpa (70PSI)	344kpa (50PSI)
Up to 200°C	172kpa (25PSI)	137kpa (20PSI)	69kpa (10PSI)
Up to 210°C	137kpa (20PSI)	34kpa (5PSI)	
Up to 220°C	68kpa (10PSI)		

Refer chart for 300LB

## DIMENSIONS

Size	Ød	L	ANSI 150LB Flange				
			D	T	C	B	n
1"(25A)	25	100	103	11.2	51	79.4	4
1½"(40A)	30	100	127	14.2	73	98	4
2"(50A)	60	200	152	15.9	92	121	4
2½"(65A)	54	230	178	17.6	105	140	4
3"(80A)	76	240	190	19.1	127	152	4
4"(100A)	102	280	228	23.6	157	191	8
5"(125A)	127	360	254	23.9	186	216	8
6"(150A)	152	460	279	25.4	216	241	8
8"(200A)	203	600	343	25.6	270	298	8
10"(250A)	250	750	406	30.3	324	362	12

12" (300NB) to 24" (600NB) refer SL8141-OVK Series drawings.  
Available with lever, gear operator or actuator. Stainless steel static grounding device is a standard feature.

## PRESSURE/TEMPERATURE (up to 150NB)

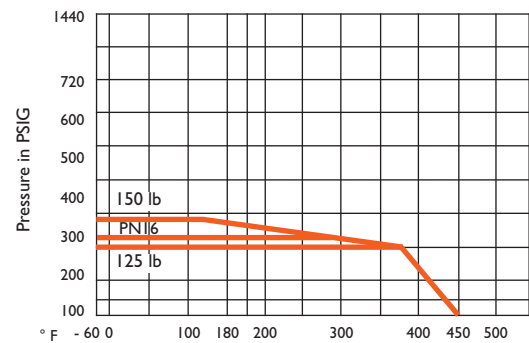

This chart applies up to 150NB only.

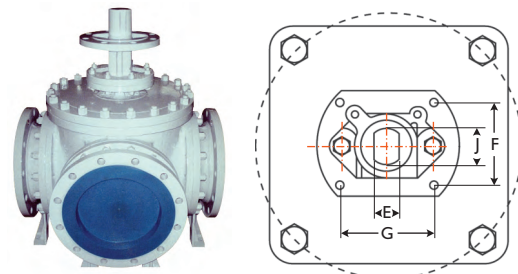

## MOUNTING PAD DIMENSIONS (MM)

Size	1½"	2"	2½"	3"	4"
E					
J					
F					
G					

As per customer requirement, refer drawing.  
(ISO 5211 Mounting Pad available)

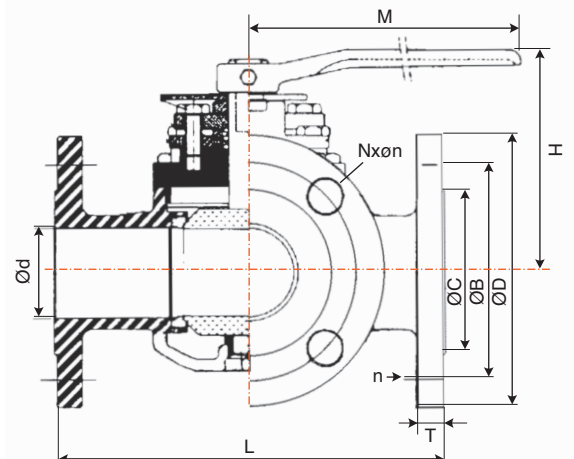

# Multiway Side Entry Unibody Ball Valve

## 8000 Series



PORT TYPE	1	2	3	4
L (3 Seat)				
T (4 Seat)				
Double L (4 way)				

- \* Individually tested in factory for zero leakage.
- \* Adjustable Gland packing.
- \* Three/Four-seat design for positive shut off in all directions regardless of entry point.
- \* Media trapped in valve cavity is substantially reduced with 4 seat design.
- \* 90 Degree turn operation. (ISO mounting on Request)
- \* Trunnion supported ball for lower torque and longer service life.
- \* 4 seat design allows even longer life by evenly distributing wear and increases leak tight integrity.
- \* Transflow style

### MODEL SL8142-FZ

Flanged Ends 3-Way 90 degree turn Ball Valves  
 Cast iron FC20, S.S 304 & 316. Full port, Cast body.  
 Size: 40NB ~ 250NB (1½" ~ 10") 150#, 300#, 600#  
 Mounting: To ANSI B16.5, ISO 521 I

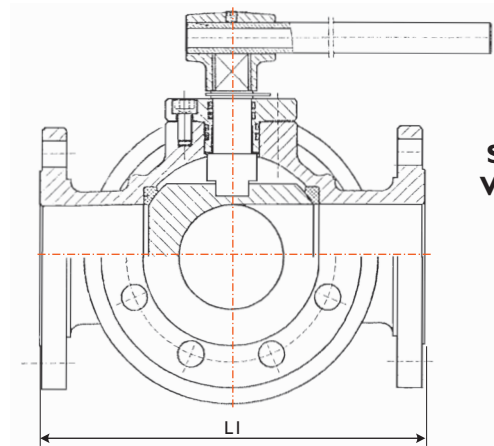

**SIDE VIEW**

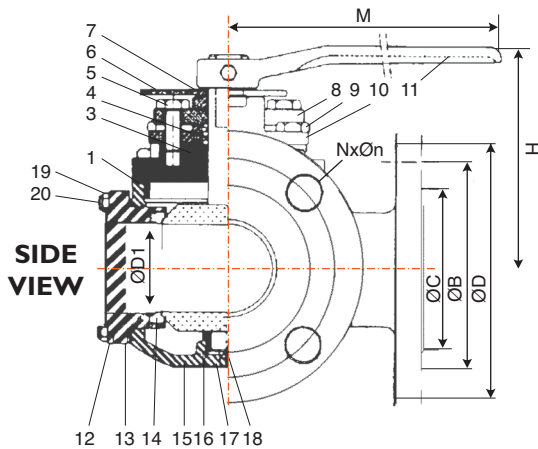

**SIDE VIEW**

3 Seat Design (4 seat for T-Port) multi-directional shut off can be used in any direction.

Flow can be directed into any inlet as these valves have 3 seats on L port and 4 seats on T port.

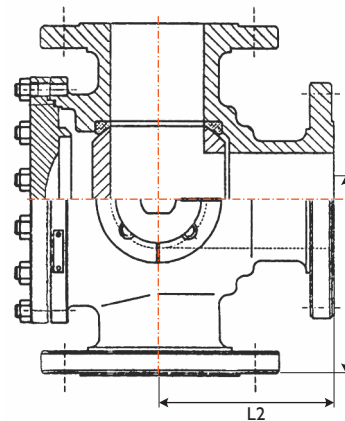

**TOP VIEW**

Now also available:- (optional)  
 Firesafe Design c/w antistatic device, graphite stem packing, graphoil/stainless body joint gaskets



### MATERIALS LIST

No	Part Name	CF8M S/S	CF8 S/S	WCB	Cast Iron	Qty
1	Gasket	PTFE	PTFE	PTFE	PTFE	1
3	Stem Packing (*2)	PTFE	PTFE	PTFE	PTFE	1
4	Gland	SUS304	SUS304	SUS304	Cast Iron	1
5	Bolt	B8	B8	B7	S45C	1
6	Stopper	SUS304	SUS304	Carbon Steel	Carbon Steel	2
7	C Retainer Ring					1
8	Bonnet Cap	ASTM A351 Gr. CF8M	ASTM A351 CF8	ASTM A216 WCB	FC-20	1
9	Bolt	B8	B8	B7	S45C	1
10	Bracket	CF8	CF8	ASTM A216 WCB	FC-20	4
11	Handle	Ductile Iron	Ductile Iron	Ductile Iron	Ductile Iron	1
12	Flange Cap	ASTM A351 Gr. CF8M	ASTM A351 CF8	ASTM A216 WCB	FC-20	1
13	Joint Gasket (*2)	PTFE or SS spiral	PTFE or SS Spiral	PTFE or SS Spiral	PTFE	3
14	Ball Seat	RPTFE	RPTFE/PTFE	RPTFE/PTFE	RPTFE/PTFE	3/4
15	Body	ASTM A351 Gr. CF8M	ASTM A351 CF8	ASTM A216 WCB	FC-20	1
16	Bushing	50/50 SS Powder/PTFE filled	50/50 SS/PTFE	50/50 SS/PTFE	50/50 SS/PTFE	1
17	Ball & Stem	ASTM A351 Gr. CF8M	ASTM A351 CF8M	ASTM A351 CF8M	ASTM A351 CF8	1
18	Anti Static (*2)	SUS304	SUS304	SUS304	SUS304	1
19	Nut	SUS304	SUS304	S45C/2H	S45C	*
20	Stud	SUS304	SUS304	S45C/B7	S45C	*
21	Bolt	B8	B8	B7	S45C	#

\* 2 Firesafe version has graphite / Spiral gaskets packings / Antistatic device #: 1-1/2"-4" = 4 PCS, 6"-8" = 8 PCS \*1-1/2"-3" = 12 PCS, 4" = 18 PCS, 6"-8" = 24 PCS

# Model SL8142-FZ

## ANSI 125# & 150# ANSI B16.5 DIMENSION (mm)

Size	øB	øC	øD	ødI	H	L1	L2	L3	M	N	øn	T	Weight Kg
1½"	98.5	73	127	39	115				385	4	15	14.3	20
2"	120.6	92	152	51	148.5	230	115		385	4	19	15.9	23
2½"	139.7	105	178	63	142	281	141	91	340				24
3"	152.4	127	191	76	163.5	278	139	146	385	4	19	19.1	29
4"	190.5	157	229	102	199	370	185		500	4	19	23.9	45
5"	254	186	254	125	220				340				46
6"	241.3	216	279	152	262.5	510	255		900	8	22	25.4	105
8"	298.5	270	343	202	284				900	8	22	28.5	
10"	362	324	406	252	360				1000	12	25	30.2	

300NB (12") Refer YP version BV509. Larger sizes up to 600NB refer drawings SL8141-OVK Series.

## ANSI 300# ANSI B16.5 DIMENSION (mm)

Size	øB	øC	øD	ødI	H	L1	L2	L3	M	N	øn	T	Weight Kg
1½"	114.3	73	156	39	115				385	4	22	21	
2"	127.0	92	165	51	148.5	260	130		385	8	19	22.5	
2½"	149.2	105	185	63	142				340				
3"	168.3	127	210	76	163.5	320	160		385	8	22	29	
4"	200.0	157	254	102	199	370	185	146	500	8	22	32	
6"	270.0	216	318	152	285	510	255		900	12	22	36.6	

200NB ~ 300NB (8"-12") Refer YP version BV509. Larger sizes up to 600NB refer drawings SL8141-OVK Series.

## ANSI 600# ANSI B16.5 DIMENSION (mm)

Size	øB	øC	øD	ødI	H	L1	L2	M	N	øn	T	Weight Kg
1½"	114.3	73	156	39	115			385	4	22	21	
2"	127.0	92	165	51	148.5	262	131	385	8	19	22.5	
2½"	149.2	105	185	63	142			340				
3"	168.3	127	210	76	163.5	322	131	385	8	22	29	

## PRESSURE/TEMPERATURE

### RATING (RPTFE) 150# ANSI WCB CF8 & CF8M BODY

Temperature	to 80NB	100NB - 150NB	200NB
Up to 60°C	1963kpa (285PSI)	1963kpa (285PSI)	1963kpa (285PSI)
Up to 80°C	1929kpa (280PSI)	1722kpa (250PSI)	1378kpa (200PSI)
Up to 130°C	1722kpa (250PSI)	1515kpa (220PSI)	1033kpa (150PSI)
Up to 140°C	1580kpa (230PSI)	1378kpa (200PSI)	861kpa (125PSI)
Up to 180°C	551kpa (80PSI)	482kpa (70PSI)	344kpa (50PSI)
Up to 200°C	172kpa (25PSI)	137kpa (20PSI)	69kpa (10PSI)
Up to 210°C	137kpa (20PSI)	34kpa (5PSI)	
Up to 220°C	68kpa (10PSI)		

Refer chart for 300LB

Rating shown above and below apply when temperature on all ports is equal and applies to the highest pressure rating on all of the ports.

## PRESSURE/TEMPERATURE (up to 150NB)

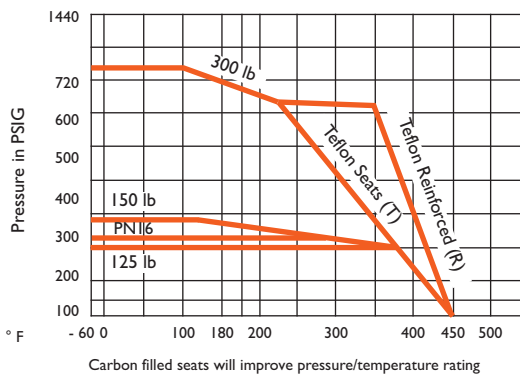

## BREAKTORQUE OUTPUT BASED ON CLEAN FLUIDS

Size	150#		300#			
	ΔP 280PSI		ΔP 400PSI		ΔP 740PSI	
	T Port	L Port	T Port	L Port	T Port	L Port
2"	96NM	80NM	118NM	105NM	140NM	120NM
2½"	156NM	150NM	190NM	179NM	287NM	180NM
3"	200NM	180NM	245NM	218NM	250NM	230NM
4"	348NM	365NM	387NM	345NM	400NM	375NM
6"	700NM	690NM	820NM	740NM	1200NM	1070NM
8"	2200NM	2060NM	-	-	-	-

## BI-DIRECTIONAL FLOW

Allows flow into the end ports and out of the common side port for mixing applications, or into the side port and out of either end port for diverting applications.

## EFFECTIVE STEM SEALING

"Corner Sealing," the compression of low friction TFE box rings, eliminates stem leakage by avoiding straight-line leakage paths. Stem seal adjustment, if ever required, is done by simply tightening bonnet screws or bolts.

	150 Class CV/Litre/Minute at 1 PSI pressure drop L Port	150 Class CV (US gallons/minute)	
		* T Port	L Port
40NB	189	200	50
50NB	529	400	140
65NB	604	650	160
80NB	982	1000	260
100NB	1625	2000	430
150NB	3326		880
200NB	5670		1500
250NB	8694		2300
300NB			

\*With all three ports open

## TOP VIEW

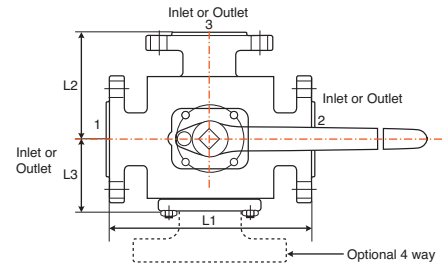

## SIDE VIEW

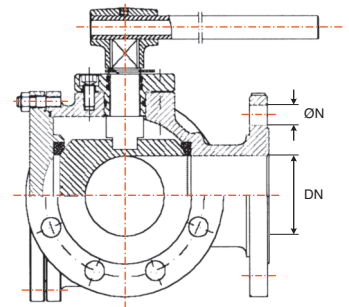

# Multiway Side Entry 2 Piece Ball Valve 9000 Series



## MODEL SL9141

Flanged Ends to ANSI B16.5 3-Way Ball Valves, 3 seats  
Cast iron FC20, S.S 304 & 316. Full port,  
Cast body. Size: 40NB ~ 250NB (1½" - 10") 150# & 300#  
Optional Mount Pad

PORT TYPE	1	2	3	4
L				
T				

\* 4 way also available.

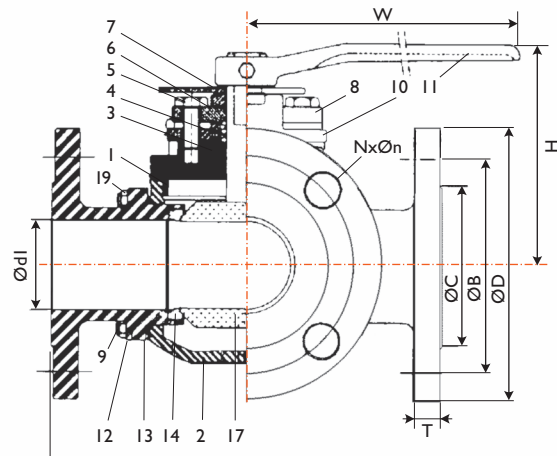
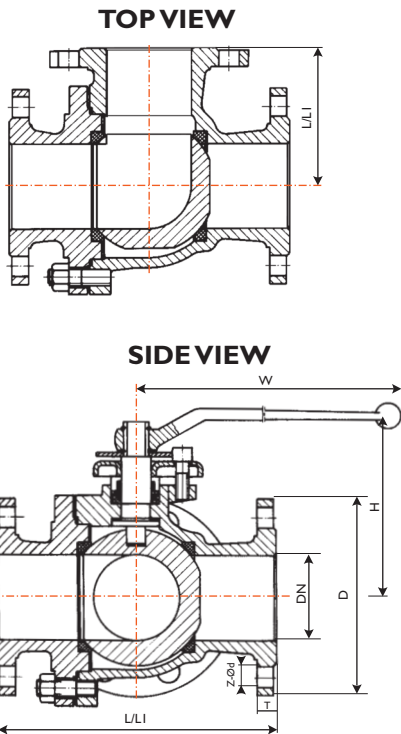

- \* Adjustable Gland packing
- \* 90 Degree turn operation. (ISO mounting on Request)
- \* Transflow style

## MATERIAL LIST

No	Part Name	CF8M S/S	CF8 S/S	WCB	Cast Iron	Qty
1	Gasket	PTFE	PTFE	PTFE	PTFE	1
2	Body	ASTM A351 Gr. CF8M	ASTM A351 CF8	ASTM A216 WCB	FC-20	1
3	Stem Packing (*2)	PTFE	PTFE	PTFE	PTFE	1
4	Gland	SUS304	SUS304	SUS304	Cast Iron	1
5	Bolt	B8	B8	B8	S45C	2
6	Stopper	SUS304	SUS304	Carbon Steel	Carbon Steel	1
7	C Retainer Ring					1
8	Bonnet Yoke	ASTM A351 Gr. CF8M	ASTM A351 CF8	ASTM A216 WCB	FC-20	1
9	Bolt	B8	B8	B7	S45C	4
10	Bracket	CF8	CF8	ASTM A216 WCB	FC-20	1
11	Handle	Ductile Iron	Ductile Iron	Ductile Iron	Ductile Iron	1
12	Body Adaptor	ASTM A351 Gr. CF8M	ASTM A351 CF8	ASTM A216 WCB	FC-20	3
13	Joint Gasket (*2)	PTFE or S/S Spiral	PTFE or S/S Spiral	PTFE or S/S Spiral	PTFE	3
14	Ball Seat	RPTFE	RPTFE/PTFE	RPTFE/PTFE	RPTFE/PTFE	3
17	Ball & Stem	ASTM A351 Gr. CF8M	ASTM A351 CF8M	ASTM A351 CF8M	ASTM A351 CF8	1
19	Nut	SUS304	SUS304	S45C / 2H	S45C	*
20	Stud	SUS304	SUS304	S45C / B7	S45C	*
21	Bolt	B8	B8	B7	S45C	#

Refer to as built as built drawing, different sizes/classes vary.

\* 2 Firesafe version has graphite / Spiral gaskets packings / Antistatic device #: 1-1/2"-4" = 4 PCS, 6"-8" = 8 PCS \*: 1-1/2"-3" = 12 PCS, 4" = 18 PCS, 6"-8" = 24 PCS



# Model SL9141

## ANSI 16.5 DIMENSION (mm)

Size		Bore		125/150lb								300lb							
inch	mm	DN	B	C	D	L	LI	H	W	T	B	C	D	L	LI	H	W	T	
1"	25	25	79	51	108	185/160	82.5/80	84	180	14	89	51	124	185/160	82.5/80	84	180	18	
1½"	40	40	98	73	127	210/220	105/100	87	180	17	114	73	156	220/200	110/100	87	230	22	
2"	50	50	121	92	152	230/220/260	115/110/130	107	230	20	127	92	165	240/230	120/115	107	230	22	
2½"	65	65	140	105	178	250/290	125/145	142	230	23	149	105	191	270/290	135/145	147	400	26	
3"	80	75	152	127	191	280/310/320	130/155/160	152	400	24	168	127	210	280/310	145/155	152	400	32	
4"	100	100	191	157	229	330/370	175/185	178	400	24	200	157	254	350/350	175/175	178	700	32	
5"	125	125	216	186	254	400	200	250	700	24	235	186	279					35	
6"	150	150	241	216	279	430/480	215/240	252	1100	26	270	216	318	480/580	230/290	252	1100	37	
8"	200	200	298	270	343	540/580	270/290	22	1100	29	330	270	381	570	285	272		41	
10"	250	250	362	324	406	550	275	342		30	387	324	445					48	

Refer as built drawing for dimensions, variations available. 300NB (12") Refer YP Version - BV509

## PRESSURE/TEMPERATURE RATING (RPTFE) 150# ANSI WCB CF8 & CF8M BODY

Temperature	to 80NB	100NB - 150NB	200NB
Up to 60°C	1963kpa (285PSI)	1963kpa (285PSI)	1963kpa (285PSI)
Up to 80°C	1929kpa (280PSI)	1722kpa (250PSI)	1378kpa (200PSI)
Up to 130°C	1722kpa (250PSI)	1515kpa (220PSI)	1033kpa (150PSI)
Up to 140°C	1580kpa (230PSI)	1378kpa (200PSI)	861kpa (125PSI)
Up to 180°C	551kpa (80PSI)	482kpa (70PSI)	344kpa (50PSI)
Up to 200°C	172kpa (25PSI)	137kpa (20PSI)	69kpa (10PSI)
Up to 210°C	137kpa (20PSI)	34kpa (5PSI)	
Up to 220°C	68kpa (10PSI)		

150 Class CV/Litre/Minute at 1 PSI pressure drop L Port		150 Class CV (US gallons/minute)	
		* T Port	L Port
40NB	189	200	50
50NB	529	400	140
65NB	604	650	160
80NB	982	1000	260
100NB	1625	2000	40
150NB	3326		880
200NB	5670		1500
250NB	8694		2300
300NB			

\*With all three ports open

- Refer chart for 300LB
- Carbon filled PTFE will withstand greater temperature.
- Rating above and on chart shown apply when temperature on all ports is equal and applies to the highest pressure rating on all of the ports.

## BREAKTORQUE OUTPUT BASED ON CLEAN FLUIDS

Size	150#		300#			
	ΔP 280PSI		ΔP 400PSI		ΔP 740PSI	
	T Port	L Port	T Port	L Port	T Port	L Port
2"	96NM	80NM	118NM	105NM	140NM	120NM
2½"	156NM	150NM	190NM	179NM	287NM	180NM
3"	200NM	180NM	245NM	218NM	250NM	230NM
4"	348NM	365NM	387NM	345NM	400NM	375NM
6"	700NM	690NM	820NM	740NM	1200NM	1070NM
8"	2200NM	2060NM	-	-	-	-

No safety factor is included.  
Running torque averages 1/3 of break torque  
For dry service or infrequent use add 45% (-10% oil)

## PRESSURE/TEMPERATURE (up to 150NB)

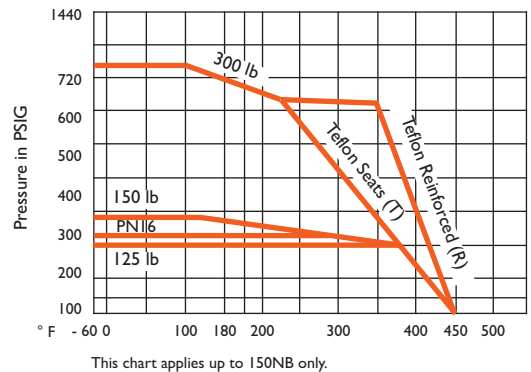

## PORT ARRANGEMENT

Option 90°

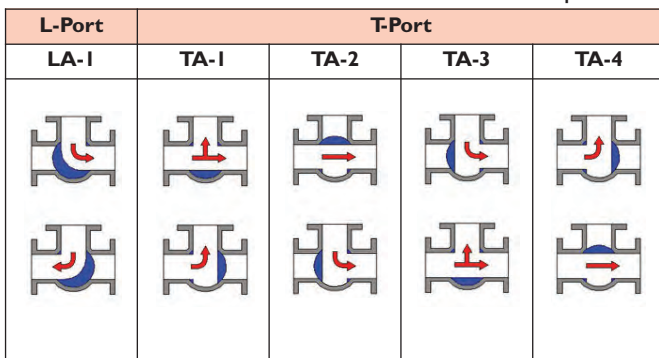

Option 180°

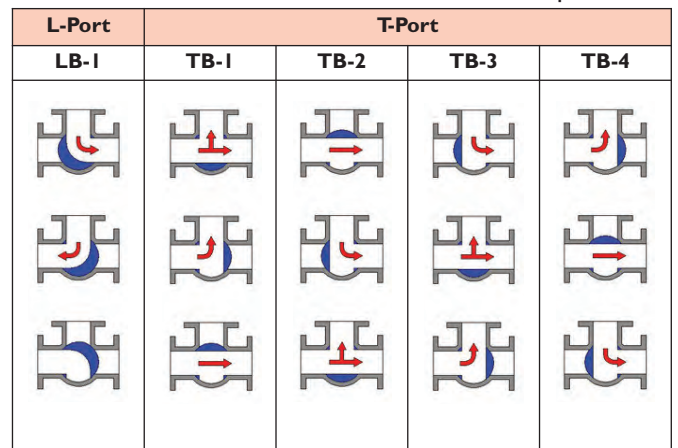

\* Other port arrangements are available upon request.

# Multiway Side Entry Spooled Body Ball Valve BV-509 Series



## MODEL BV-509

- Full Port
- Available in T-port, L-port, 3-way, 4-way, 5-way configuration.
- NPT & flanged (NPT see BV-505 data sheet)
- For food and general chemical service applications
- Self-adjusting stem packing
- Blow-out-proof stem design
- ISO 5211 actuator mounting pad on request.
- In-line repairable
- 90-degree handle movement, or 180-degree when specified.
- Carbon or stainless steel body construction
- Hydrostatic test pressure per API598
- 100% air tested under water at 100 psi, open and closed positions

## SPECIFICATIONS

- Working Pressure: PN 10/16/25/40/60  
150lbs, 300lbs, 600lbs, 900lbs  
(Higher rating on request)
- Temperature Range: -40 to 232°C (-40 to 450°F)
- Flange Dimension: ISO (DIN) PN10/16 & PN25/40  
ANSI 150lbs & 300lbs

L-PORT

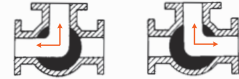

T-PORT

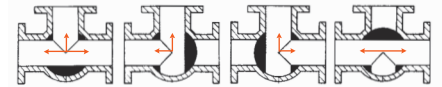

**BV-509 DN15~50 (1/2"-2")**



**BV-509-DE DN15~50 (1/2" - 2")  
(To 3000 PSI)**



**BV-509-YP DN65~300 (2 1/2" - 12")**

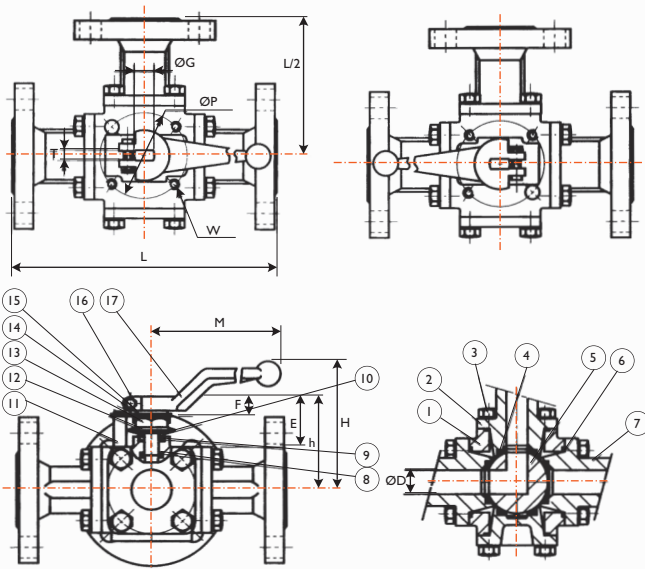

## MATERIALS LIST

Item	Part Name	Standard Material	Qty
1	Body	ASTM A351 Gr. CF8M	1
2	End	ASTM A351 Gr. CF8M	1
3	Bolts, Spring Washers	SS304	16-20
4	Ball Seats	PTFE + 15% Glass Fibre	4-5
5	Ball	SS316	1
6	Gaskets	PTFE	1
7	End Caps	ASTM A351 Gr. CF8M	3-5
8	Thrust Washer	PTFE + 15% Carbon Fibre	1
9	Stem Packing	PTFE	1 set
10	Gland	SS304	1
11	Stopper	SS304	1
12	Packing Spring	SS301	1 set
13	Stem Nut	SS304	1
14	Nut Stop	SS304	1
15	Plate Stop	SS304	1
16	Bolt, Nut	SS304	1
17	Handle	SS304	1

2 1/2" - 12" (DN65~300). Refer to separate drawing.

## DIMENSIONS (MM)

Size	D	H	M	P	W	G	T	h	E	F	L				Torque CMKGS
											PN16	PN40	ANSI 150	ANSI 300	
1/2"	15.5	65	145	50	M6	M10	6.5	51.5	25	11	160	160	152	162	150
3/4"	20	70	165	50	M6	M12	8	55.5	26	11	177	177	167	179	200
1"	25	75	195	70	M8	M14	9.7	69	36	15	191	191	185	196	300
1 1/2"	32	90	250	70	M8	M18	12	89.5	51	25	209	209	201	207	450
1 1/2"	38	95	250	102	M10	M18	12	98.5	51.5	25	234	234	145/220	224	650
2"	50	130	340	102	M10	M24	15	120	61	28	273	273	202/253	259/270	900

DN65~300 (2 1/2" - 12") refer to separate drawing. ANSI 600 to 900 Class. Refer to drawing.

## PRESSURE / TEMPERATURE

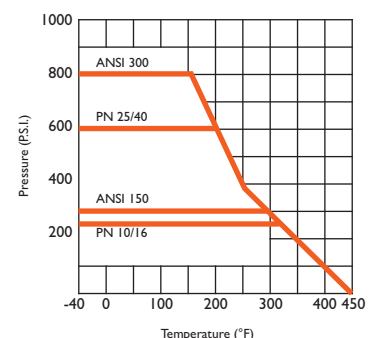

# Multiway Side Entry Spooled Body Ball Valve

## BV-509-KI Series



Screwed/Weld Ends  
65NB ~ 100NB (2½" ~ 4")

### MATERIALS LIST

Item	Part Name	Materials
1	End Cap	CF8M
2	Body	CF8M
3	Ball & Stem	SS316
4	Housing	PTFE+Stainless
5	Seats	PTFE
6	Gaskets	PTFE
7	O-Ring	VITON
8	Stem Packing	PTFE
9	Gland Washer	SS 304
10	Disc Washer	SS 301
11	Gland	SS 304
12	Handle Head	A351 Gr.CF8
13	Stop Pin	SS 304
14	Bolt	SS 304
15	Handle	Steel Pipe
16	Blank Cap	CF8M
17	Bolt	SS 304
18	End Cap Bolts	SS 304
19	Bolt Nuts	SS 304
20	Stop Pin Nut	CF8M
21	Bonnet	SS 304
22	Bonnet Gasket	PTFE

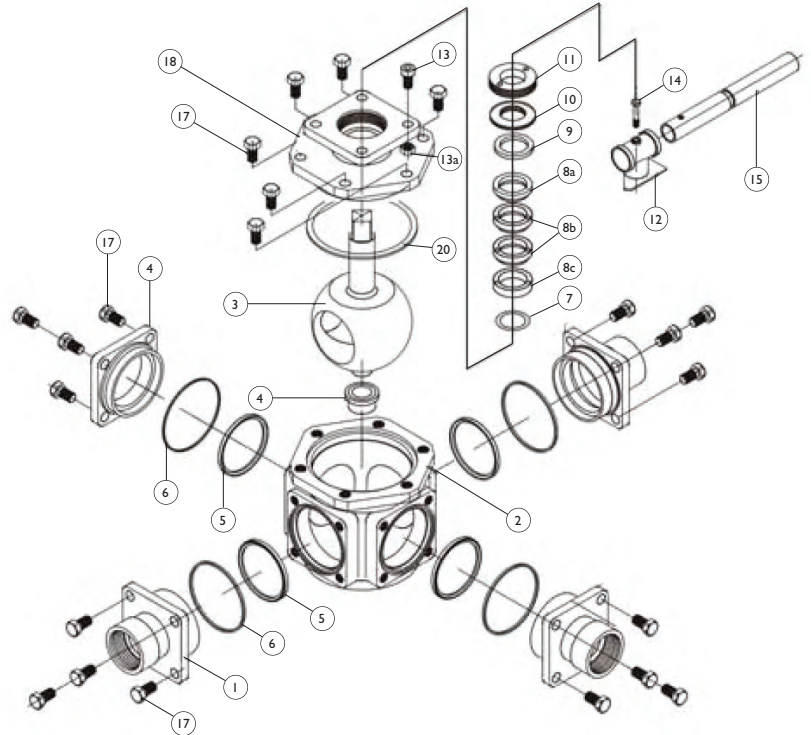

Available in 180° operation.  
This design will allow more  
flow pattern options.

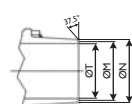

Butt Weld

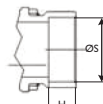

Socket Weld

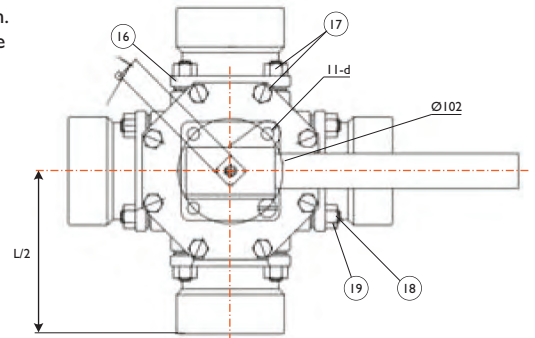

### DIMENSIONS (MM)

Size	A	B	C	E	L	L (BW)	H	S	T	M	N	3-Way W (kg)	4-Way W (kg)
2-½"	62	65	400	144	265	265	23	73.9/77 (DIN)	65	70	77	22.7	23.6
3"	76	80	500	162	290.6	290.6	23	89.6	80	85	91	31.2	31.8
4"	96	100	650	182	345	345	23	115	100	100	115	53.4	54.2

### BREAK-TORQUE VALUE (Nm)

Size (Full Bore)	¼	¾	½	¾	1	1-¼	1-½	2	2-½	3	4
Size (Red. Bore)	-	1/4~1/2	3/4	1	1-1/4	1-1/2	2"	-	-	-	-
Grease	10.3	10.3	12.8	15.4	32.1	34.6	55.3	71.8	134.7	147.5	237.3
Non-Grease	15.4	15.4	16.2	19.5	38.4	41.3	63.4	96.2	229.0	258.2	427.5

Note 1: The greases Flowturn uses including lubricant & anti-seize grease are both silicon free.  
Note 2: 30%-40% for safety factor if mounting actuator.

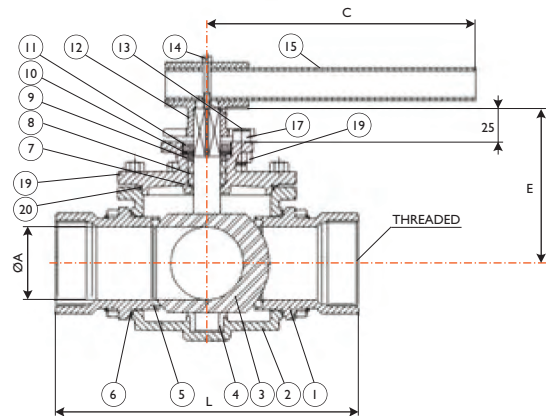

Valve can be supplied with cavity filler in internal body area in inner cavities. This will assist in keeping the body cavity clean and easy to cleanse. The cavity filler will keep the ball operation from sticking due to high viscous like media.

# Multiway Screwed / Weld End Ball Valve BV-505 Series

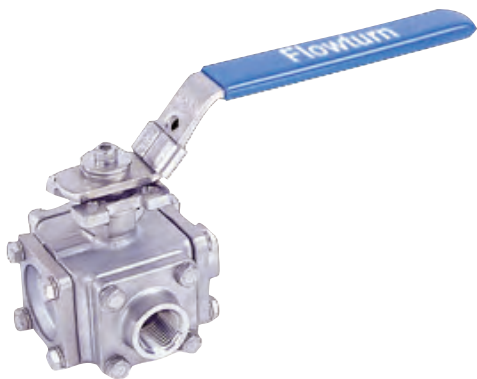

1/4"-2" (DN6-50)

## MODEL BV-505

- Available in T-port, L-port, 3-way, 4-way, 5-way configuration.
- For food and general chemical service applications.
- Self-adjusting stem packing.
- Blow-out-proof stem design.
- ISO 5211 actuator mounting pad.
- In-line repairable.
- Available with a stopper and lock down stop plate.
- 90-degree handle movement or 180-degree when specified.
- Carbon or stainless steel body construction.
- 100% air tested under water at 100psi, open and closed positions.
- Hydrostatic test pressure: 1500 psi.

## SPECIFICATIONS

- Working Pressure: 1000 psi WOG.  
(Higher pressure available)
- Temperature Range: -40 to 450°F.

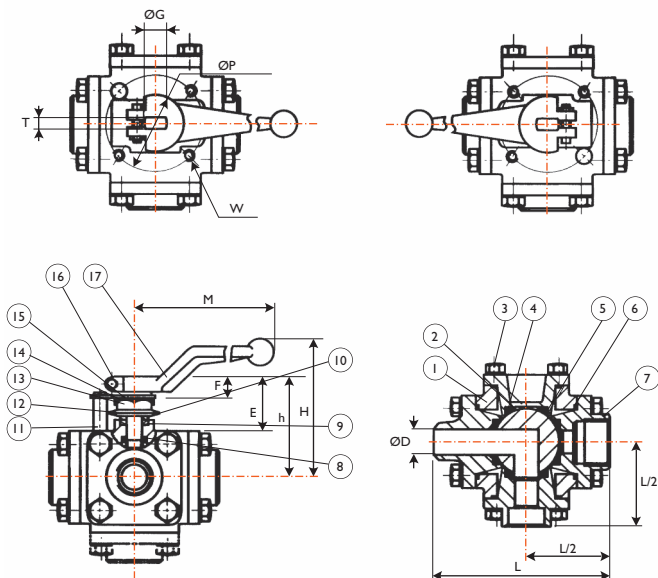

## MATERIALS LIST

Item	Part Name	Material	Option	Qty
1	Body	ASTM A351 Gr. CF8M	CF8, WCB	1
2	End	ASTM A351 Gr. CF8M	CF8, WCB	1
3	Bolts, Spring Washers	SS304	-	16-20
4	Ball Seats	PTFE + 15% Glass Fibre	Graphite Carbon Filled Teflon	4-5
5	Ball	SS316	-	1
6	Gaskets	PTFE	-	1
7	End Caps	ASTM A351 Gr. CF8M	CF3M, CF8, WCB	3-5
8	Thrust Washer	PTFE + 15% Carbon Fibre	-	1
9	Stem Packing	PTFE	-	1 set
10	Gland	SS304	SS316	1
11	Stopper	SS304	-	1
12	Packing Spring	SS301	-	1 set
13	Stem Nut	SS304	-	1
14	Nut Stop	SS304	-	1
15	Plate Stop	SS304	-	1
16	Bolt, Nut	SS304	-	1
17	Handle	SS304	-	1

## DIMENSIONS (MM)

Size		D	H	M	P	W	G	T	H	E	F	L	Torque CM-KGS
Full Port	Reduced Port												
1/4" - 3/8"	1/2"	12	55	145	50	M6	M10	6.5	41.5	20	9.5	85	110
1/2"	3/4"	15.5	65	145	50	M6	M10	6.5	51.5	25	11	102	150
3/4"	1"	20	70	165	50	M6	M12	8	55.5	26	11	111	200
1"	1 1/4"	25	75	195	70	M8	M14	9.7	69	36	15	122	300
1 1/2"	1 1/2"	32	90	250	70	M8	M18	12	89.5	51	25	135	450
1 1/2"	2"	38	95	250	102	M10	M18	12	98.5	51.5	25	155	650
2"	-	50	130	340	102	M10	M24	15	120	61	28	187	900

2.5" to 4" screwed ends also available see SL8141-SP

## PRESSURE / TEMPERATURE

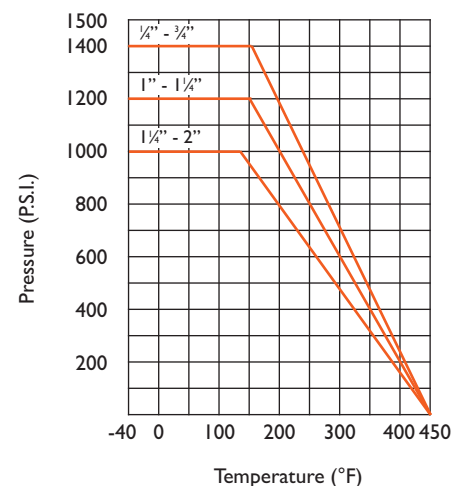

# Multiway Screwed End Ball Valve BV-2058 Series



## MODEL BV-2058

Flowturn 3-way valves provide lateral diverting flow from a common inlet to either side exit with a quarter turn, alternatively diverting flow from a single source to two different lines. The valve is a Transflow-Diverting type, so the possibility of completely stopping flow during port positioning is eliminated. However, this also means probable product mixing during a portion of the port change. Care must be taken at a blocked port not to exceed that of the flowing media by more than 250 psi, or temperature at the blocked port not to exceed flowing media more than 93°C (200°F). The valves are designed for flow either into or out of the common side port. These valves are 90 degree turn, side entry, available in reduced and full port.

PORT TYPE	1	2	3	4
L				
T				

## FEATURES

- The thread ends conform to ASME B1.20.1 (NPT) DIN 2999 & BS 21 ISO 228/1 & ISO 7/1 & BSPT
- Investment casting
- Blow-out proof stem
- Reduced bore (Full bore on request)
- 1000 psi W.O.G.
- 15% glassfiber fill PTFE reinforce seat, seal, packing
- Mounting pad tapping (option)
- L port-2058L
- T port-2058T

## PRESSURE TEMPERATURE RATING

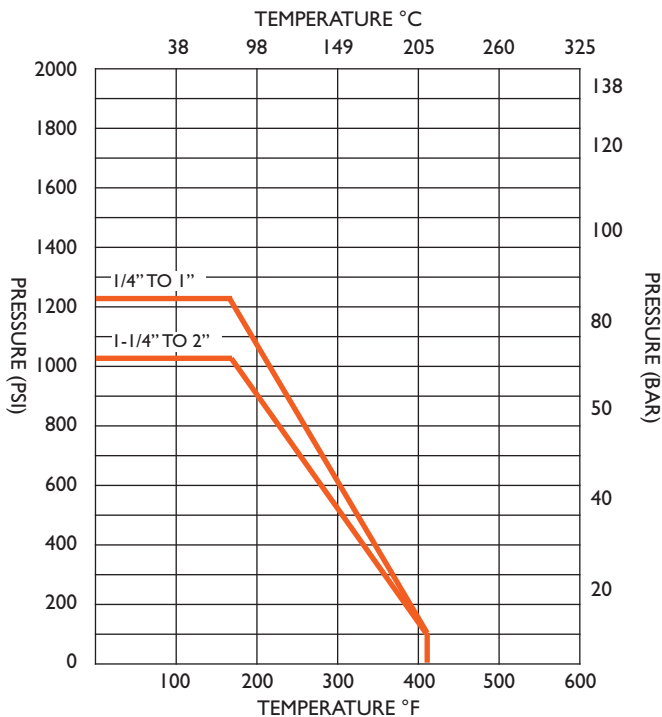

## MATERIALS LIST

Part Name	Material
Body	ASTM A351-CF8M
Retainer	ASTM A351-CF8M
Ball	ASTM A351-CF8M
Stem	AISI 316
Handle	AISI 304
Disc	AISI 304
Nut & Washer	AISI 304
Ball Seat	R-PTFE
Body Seal	PTFE
Stem Packing	PTFE
Thrust Washer	PTFE
Handle Sleeve	Vinyl

# Model BV-2058

## DIMENSIONS T-PORT

SIZE	Ød	L	L2	H	W	W1	W2	Cv
½"	12.7	75/80	38/40	59	126	22.4	35	6
¾"	16	86/88	43/44	64	126	22.4	35	12
1"	20	101/109	50/54	80	145	22.4	35	14
1¼"	25	115/125	58/63	90	145	25.4	38	24
1½"	32	125/143	63/72	96	204	25.4	38	30
2"	38.1	147/161	124/82	106	204	25.4	38	50

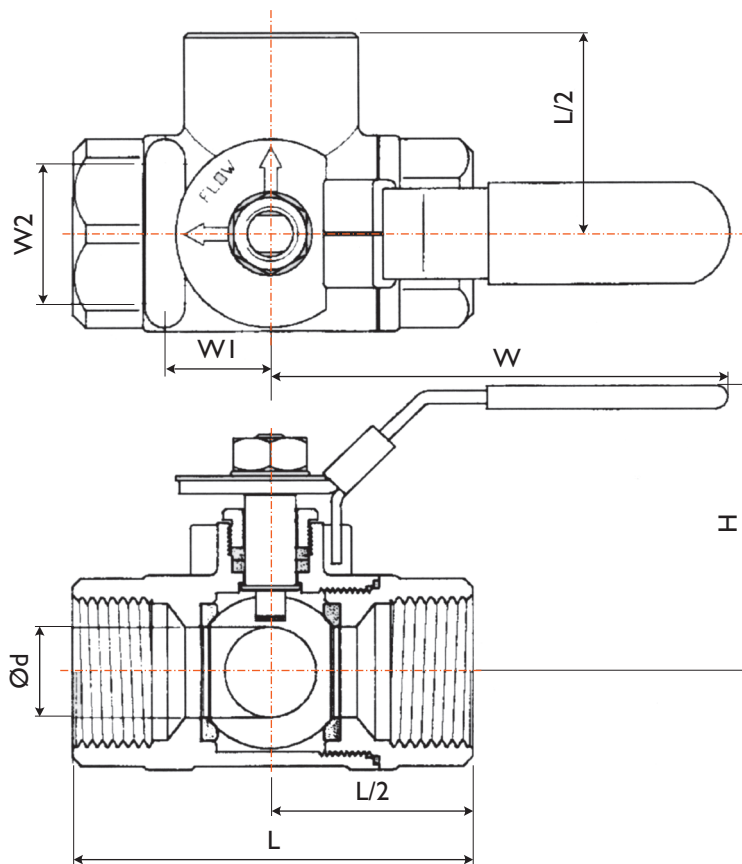

## DIMENSIONS L-PORT

SIZE	Ød	L	L2	H	W	W1	W2	Cv
¾"	10	65/64/80	33/32/40	53	97	22.4	35	6
½"	12.7	75/64/80	38/32/40	53	97	22.4	35	6
¾"	16	75/76/87	37/38/44	63	126	22.4	35	12
1"	20	100/87/109	52/43/54	66/83	126	22.4	35	14
1¼"	25	115/96/125	58/48/63	81	145	22.4	35	24
1½"	32	125/114/143	63/57/72	83	145	25.4	38	30
2"	38.1	146/142/161	73/62/82	96	204	25.4	38	50

# Multiway Screwed End Brass Ball Valve 3L3200 Series



## MODEL 3L3200 BOTTOM ENTRY 180 DEGREE OPERATION

Vertical Flow Diverting Valve is designed to accept media through the bottom (inlet port) and to direct the product out to either of the two side ports. With this configuration, the flow can be shut off by simply operating the valve 90 degrees; however, there is no stop arrangement for this position. These valves are versatile and are designed for flow either into or out of the common bottom port.

The 3L-3200 is a Non-Transflow Valve, as flow will be blocked at the 90 degree point of rotation. This also means no mixing of products during valve port position change. The valve requires 180 degree rotation with line flow shut off at the inlet or bottom port with 90 degree rotation, and full diverter flow to opposite port resuming with 180 degree rotation.

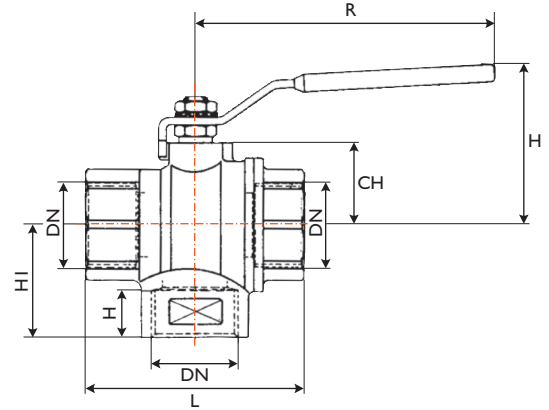

### MATERIALS LIST

Part Name	Material
Body	Brass
End Caps	Brass
Ball	Chrome Plated Brass
Ball Seats	PTFE
Packing	PTFE
Packing Gland	Nickle Plated Brass
Nut	Nickle Plated Brass
Stem	Nickle Plated Brass
Washer	Plated Steel
Bolt	Plated Steel
Handle	Plated Steel/Vinyl Cover

Valves can be automated as an actuator can be mounted over the valve stem - which is directly over the inlet port of the valve. It is important to note that the valve requires 180 degree actuation.

Ball valves normally have a space between the ball and inside body which could trap product. Care should always be taken to properly drain this cavity.

High pressure forged steel 3 way valves to 3000 PSI also available up to 80 NB in our range.

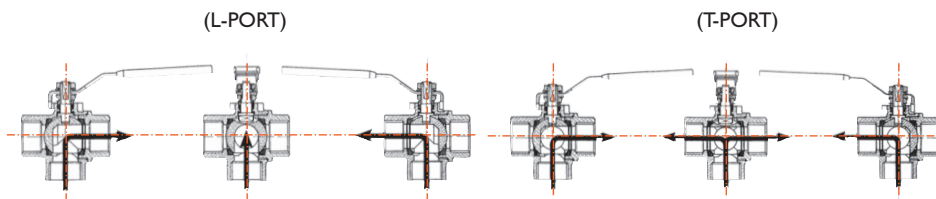

DN	CH	I	H	HI	R	L	KVART		PN	COLD WORKING PRESSURE (PSI)	TORQUE (NM)	
							T-Port	L-Port			T-Port	L-Port
8	22	11.5	41	25.5	96	51	1.5	2.25	25	360	1	1
10	22	11.5	41	25.5	96	51	1.8	2.7	25	360	1	1
15	27	15	44	31	96	59	3.9	6	25	360	1.5	4
20	32	16.5	53	37	117	71	7.9	11.5	16	232*	3	7
25	41	19	57	43.5	117	84	13	18.3	16	232*	4	8
32	50	21.5	61.5	51	117	96	20.7	27.2	10	145*	5	14
40	55	21.5	76	57.5	152	106	38.7	47.3	10	145*	6	23
50	70	25.7	83	69	152	127	54	73	10	145*	9	15
80	105	32	149	105	260	197	145.7	177.5	6	87*	22	102

\* Reduced bore model available will do 400 PSI to 1" and 280 PSI to 3"  
Temperature:- 200°C max, note pressure rating is reduced as temperature increases

# Hygienic Quarter Turn Valves



A variety of options are available in weld ends, screwed ends or wafer "flangeless" type. Trim is teflon and stainless but for hygienic service the ball / disc can also be coated with teflon or polished (or lined if required). 2 way, 3 way, 4 way & 5 way available. A detailed data sheet can be supplied on items of interest.

**TYPE FV01**

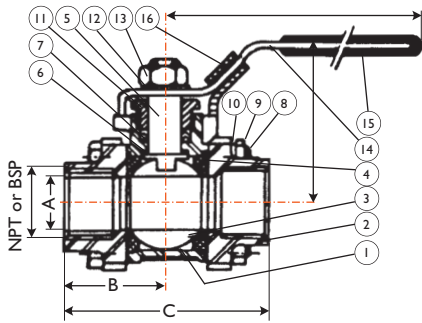

Ball valve, 3 piece, available in Butt weld (tube or pipe), BSP or socket weld. For extra cost valves can be supplied to hygienic specification.

**TYPE FV02**

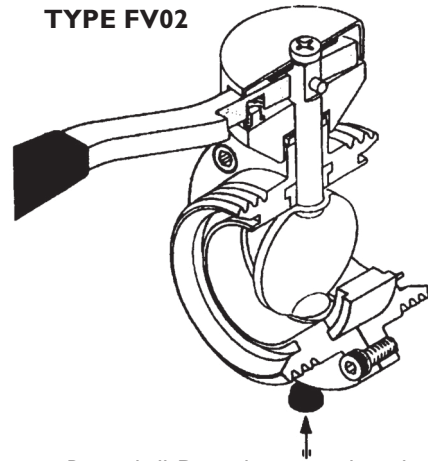

Hygienic Butter-ball. Does the same job as the traditional food / wine ball valve but at a lower cost. Available in special male threads as well as in flangeless configuration.

**TYPE FV03**

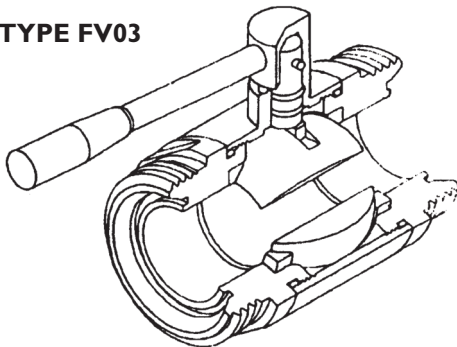

Hygienic ball type available with various end connections.

**TYPE FV04**

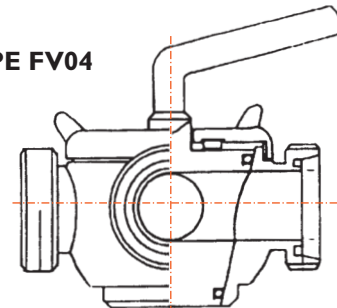

3/4 way ball valve traditional milk valve style.

**TYPE FV05**

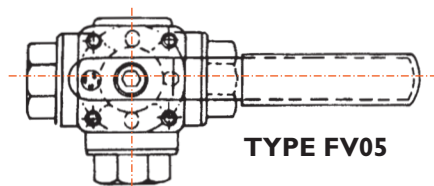

Standard 3-4 or 5 way ball valve, (also available in flanged ends in larger sizes).

**TYPE FV06**

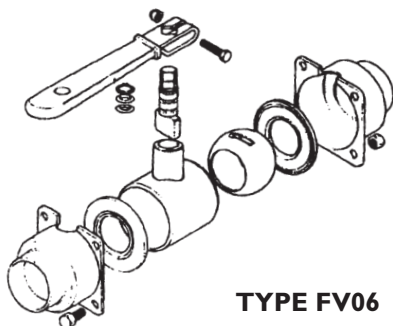

Hygienic ball valve.

**WAFFER STYLE 2014**

Flangeless (wafer style) teflon lined butterfly valve. Also available in lugged.



# Notes

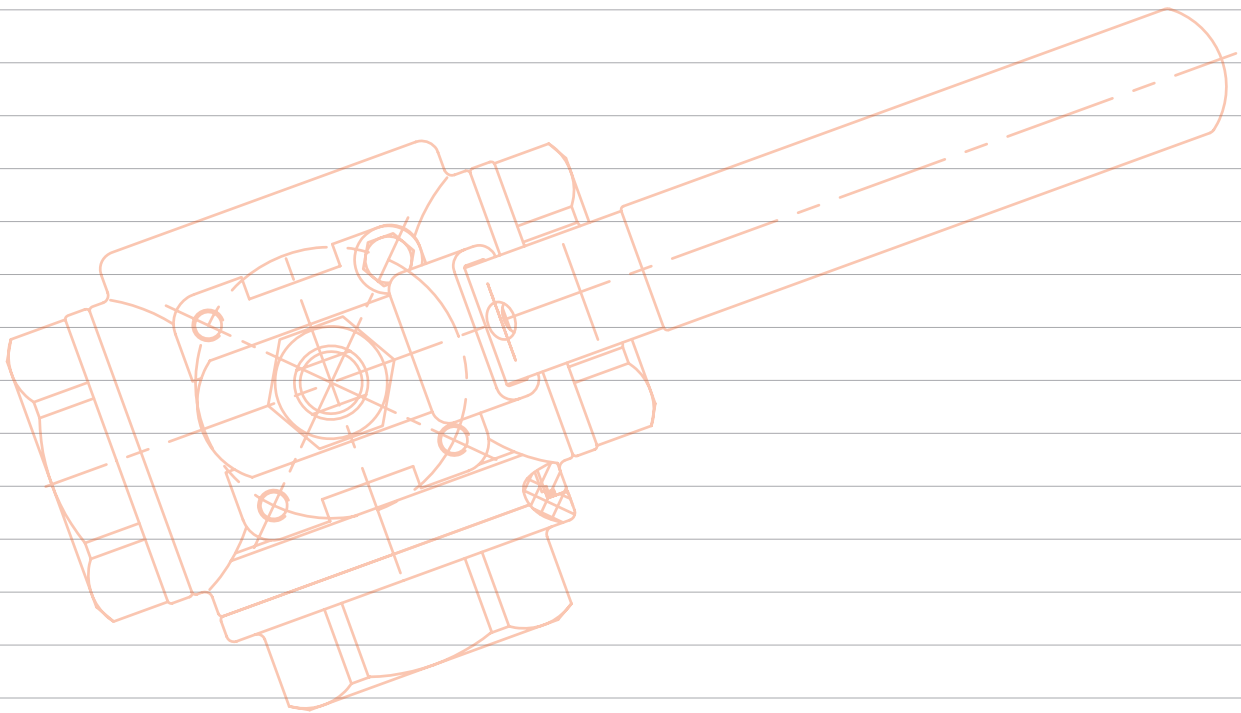

# Notes

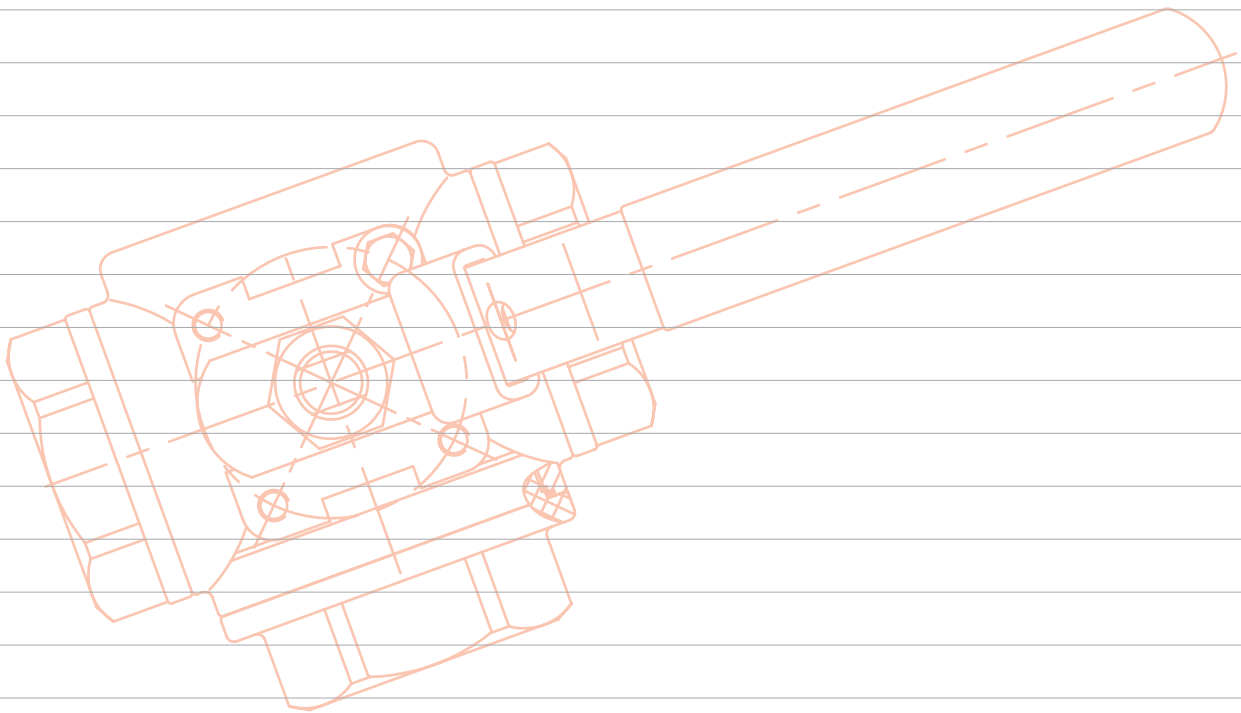



**AUSTRALIAN PIPELINE VALVE®**

**COMPLETE PRODUCT LINE**

*“Australian Pipeline Valve produces isolation, control and flow reversal protection products for severe and critical service media in utility, steam, pipelines, oil & gas and process industries. APV valves and pipeline products form the most competitive portfolio in the market.”*



**AUSTRALIAN PIPELINE VALVE BRAND RANGE - CATALOGUES**

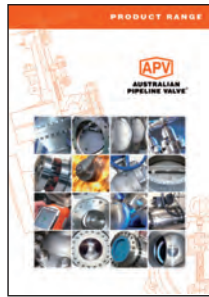

Product Brochure



Ball Valves Floating & Trunnion Mounted



Ball Valves Floating Small Bore

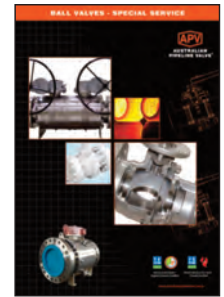

Ball Valves Special Service



Oilfield Products Valves & Wellheads



Gate, Globe & Check Valves - Cast



Gate, Globe & Check Valves - Forged Steel



Plug Valves Lubricated, Sleeved & Lined

**APV FAMILY OF BRANDS RANGE - CATALOGUES**



Diamond Gear Gearboxes



Flowturn Ball Valves Multiway & Deadman



Flowturn Gate, Globe & Check Valves



Flowturn Instrument Valves



Flowturn Strainers & Sight Glasses



Steamco Steam Valves

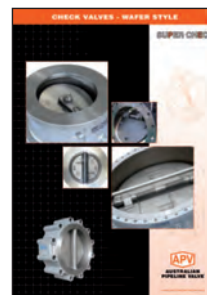

Supercheck Wafer Check Valves



Superseal Butterfly Valves



Superseal Industrial Ball Valves



Torqturn Actuators



TwinLok Tube Fittings



Uniflo Check Valves

Contact us for your local stockist/distributor



# AUSTRALIAN PIPELINE VALVE®

ADELAIDE • BRISBANE • PERTH

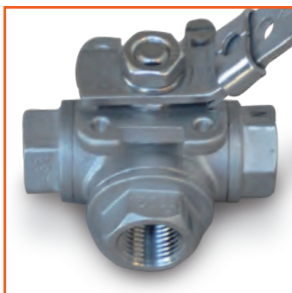

[www.australianpipelinevalve.com.au](http://www.australianpipelinevalve.com.au)

LOCAL DISTRIBUTOR



## QUALITY ASSURANCE AND CERTIFICATION

*We are continually improving all facets of quality assurance. Full metallurgical and test certificates are always supplied for all pressure retaining parts.*

*We have endeavoured to provide a broad outline of our range and capabilities. Because we are continually developing new products for our customers this catalogue will, to some extent be incomplete. This catalogue is a general overview only, individual drawings and data sheets can be furnished on request.*

*If you have any requirement in the field of valves, please contact us for a prompt response. Continuous development of Australian Pipeline Valve products may necessitate changes in the design or manufacturing processes. Australian Pipeline Valve reserves the right to effect any such changes without prior notice.*

