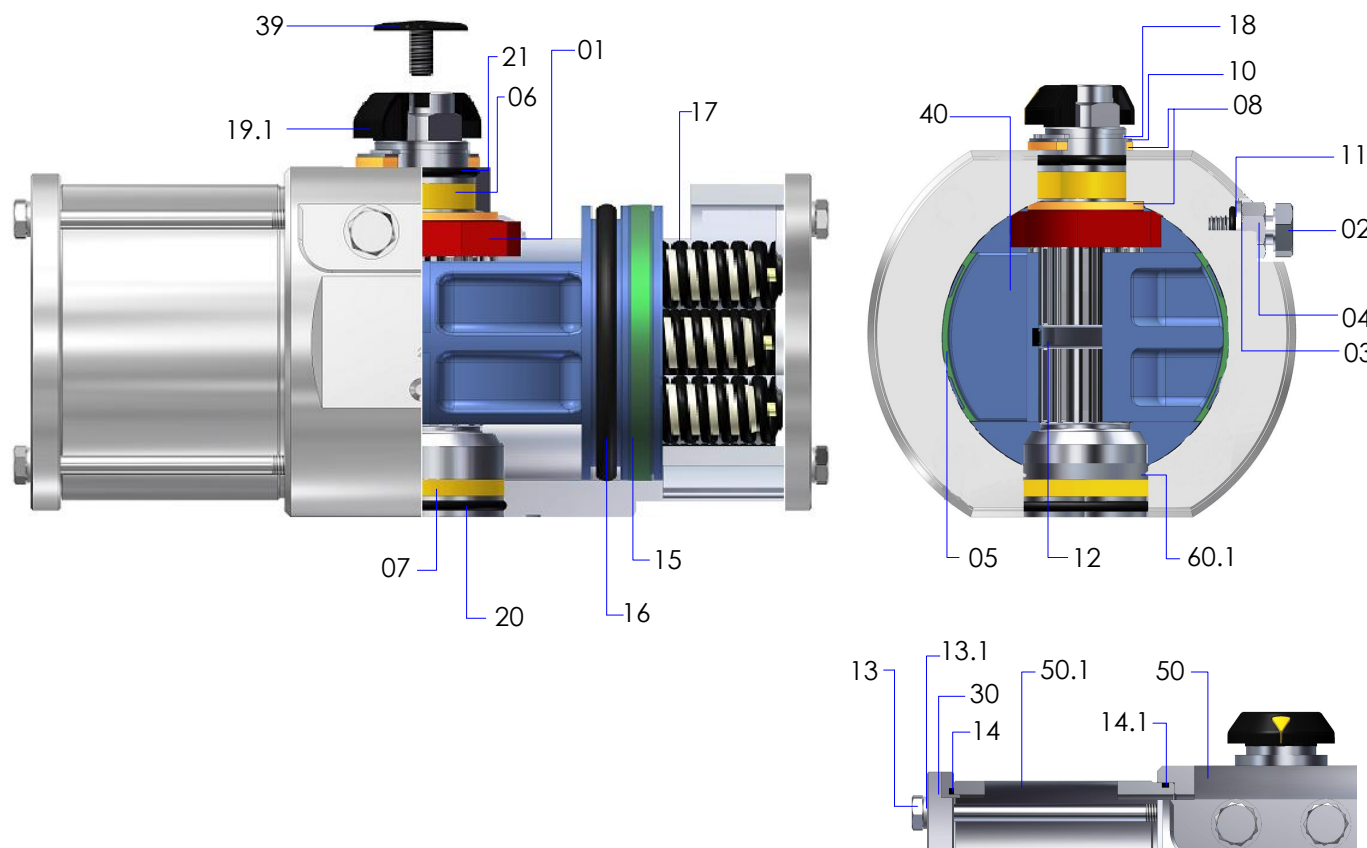

**Material and Construction**

PART N°	Spare Parts	UNIT Q.TY / NOTE	PART DESCRIPTION	STANDARD MATERIAL (A) (B)
01		1	OCTI-CAM (Stop arrangement)	Carbon Steel, zinc coated
02		2	STOP CAP SCREW	Stainless Steel A2 70 (ISO3506) / OPTIONAL Stainless Steel A4 70
03		2	WASHER	Stainless Steel A2 (ISO3506) / OPTIONAL Stainless Steel A4 70
04		2	NUT (Stop screw)	Stainless Steel A2 70 (ISO3506) / OPTIONAL Stainless Steel A4 70
05	○	2	BEARING (Piston back)	PA46
06	○	1	BEARING (Pinion top)	HGP
07	○	1	BEARING (Pinion bottom)	HGP
08	○	2	THRUST BEARING (Pinion)	PA46
10		1	THRUST WASHER (Pinion)	Stainless Steel AISI 304
11	○ □	2	"O" RING (Stop screw)	M-NBR
12		2	PISTON GUIDE	PA66+GF
13		8	CAP SCREW (End cap)	Stainless Steel A4 70 (ISO3506)
13.1		8	WASHER (Cap Screw and cap)	Stainless Steel A4
14	○ □	2	"O" RING (End cap)	M-NBR
14.1	○ □	2	"O" RING (Body Extensions)	M-NBR
15	○	2	BEARING (Piston head)	POM
16	○ □	2	"O" RING (Piston)	M-NBR
17		max. 12	SPRING (Cartridge)	SiCr Spring alloy Steel epoxy coated
18		1	SPRING CLIP (Pinion)	Stainless Steel AISI 302
19.1		1	POSITION INDICATOR	PA66+GF+CB
20	○ □	1	"O" RING (Pinion bottom)	M-NBR
21	○ □	1	"O" RING (Pinion top)	M-NBR
30		2	END CAP	Stainless Steel 1.4401 (EN 10088-3) / F316 (ASTM A 182)
39		1	CAP SCREW (Indicator)	PA66+GF+CB
40		2	PISTON	Pressure Die Cast Aluminium alloy, anodized
41		1	ACTUATOR IDENTIFICATION LABEL	Polyester-Silver
50		1	BODY	Stainless Steel 1.4401 (EN 10088-3) / F316 (ASTM A 182)
50.1		2	BODY EXTENSIONS	Stainless Steel 1.4401 (EN 10088-3) / F316 (ASTM A 182)
60.1		1	INTEGRAL DRIVE SHAFT	Stainless Steel 1.4401 (EN 10088-3) / F316 (ASTM A 182)

○ Parts included in Complete spare parts kit

□ Parts included in "O" ring spare parts kit

## Notes:

A) For different soft parts material depending on operating temperature range refer to T.D.S S00501E.

B) For the type of surface finishing see catalogue SS-E-XX.