

AS 2129* STEEL PLATE BLIND FLANGES

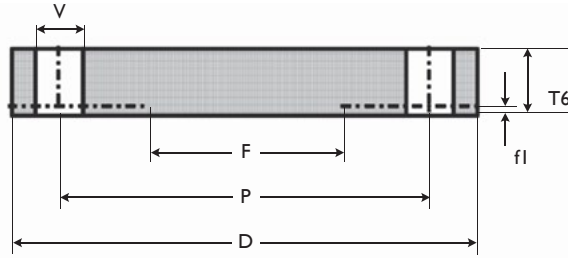

TABLE D DIMENSIONS (mm)

Size		Flange Outside Diam.	Raised Face†		Bolting Details			Flange Thickness**	Net Weight	
mm	inch		Diam.	Thickness	Pitch Circle	Number of Holes	Diam. of Holes	FF & RF	RF†	FF
mm	inch	D	F	fl	P	N	V	T6	Kg	Kg
15	1/2	95.00	47.00	1.60	67.00	4	14.00	12.00	0.19	0.25
20	3/4	100.00	53.00	1.60	73.00	4	14.00	12.00	0.22	0.28
25	1	115.00	65.00	1.60	83.00	4	14.00	12.00	0.30	0.38
32	1 1/4	120.00	67.00	1.60	87.00	4	14.00	12.00	0.41	0.50
40	1 1/2	135.00	78.00	1.60	98.00	4	14.00	12.00	0.53	0.65
50	2	150.00	90.00	1.60	114.00	4	18.00	12.00	0.92	1.05
65	2 1/2	165.00	103.00	1.60	127.00	4	18.00	12.00	1.13	1.28
80	3	185.00	122.00	1.60	146.00	4	18.00	12.00	1.85	2.03
100	4	215.00	154.00	1.60	178.00	4	18.00	12.00	2.56	2.77
125	5	255.00	186.00	1.60	210.00	8	18.00	12.00	4.73	5.00
150	6	280.00	211.00	1.60	235.00	8	18.00	13.00	5.77	6.08
175	7	304.80		1.60	260.35	8	18.00		7.98	8.12
200	8	335.00	268.00	1.60	292.00	8	18.00	13.00	8.41	8.79
225	9	358.77		1.60	323.85	8	18.00		11.40	11.70
250	10	405.00	328.00	1.60	356.00	8	22.00	16.00	15.28	15.80
300	12	455.00	378.00	1.60	406.00	12	22.00	19.00	23.00	23.57
350	14	525.00	438.00	1.60	470.00	12	26.00	22.00	35.54	36.29
375	15	550.00	463.00	1.60	495.00	12	26.00	22.00	42.90	43.01
400	16	580.00	489.00	1.60	521.00	12	26.00	22.00	43.65	44.53
450	18	640.00	532.00	1.60	584.00	12	26.00	25.00	60.71	61.88
500	20	705.00	609.00	1.60	641.00	16	26.00	29.00	85.79	86.93
550	22	760.00	637.00	1.60	699.00	16	30.00	29.00	118.97	119.30
600	24	825.00	720.00	1.60	756.00	16	30.00	32.00	129.98	131.44

TABLE E DIMENSIONS (mm)

Size		Flange Outside Diam.	Raised Face†		Bolting Details			Flange Thickness**	Net Weight	
mm	inch		Diam.	Thickness	Pitch Circle	Number of Holes	Diam. of Holes	FF & RF	RF†	FF
mm	inch	D	F	fl	P	N	V	T6	Kg	Kg
15	1/2	95.00	47.00	1.60	67.00	4	14.00	12.00	0.25	0.30
20	3/4	100.00	53.00	1.60	73.00	4	14.00	12.00	0.28	0.34
25	1	115.00	65.00	1.60	83.00	4	14.00	12.00	0.45	0.54
32	1 1/4	120.00	67.00	1.60	87.00	4	14.00	12.00	0.58	0.67
40	1 1/2	135.00	78.00	1.60	98.00	4	14.00	12.00	0.86	0.97
50	2	150.00	90.00	1.60	114.00	4	18.00	12.00	1.18	1.31
65	2 1/2	165.00	103.00	1.60	127.00	4	18.00	12.00	1.45	1.60
80	3	185.00	122.00	1.60	146.00	4	18.00	12.00	2.06	2.23
100	4	215.00	154.00	1.60	178.00	8	18.00	13.00	3.30	3.50
125	5	255.00	186.00	1.60	210.00	8	18.00	14.00	5.11	5.39
150	6	280.00	207.00	1.60	235.00	8	22.00	17.00	7.50	7.81
175	7	304.80		1.60	260.35	8	18.00		11.90	12.10
200	8	335.00	264.00	1.60	292.00	8	22.00	19.00	12.31	12.69
225	9	358.17		1.60	323.85	12	22.00		20.10	20.70
250	10	405.00	328.00	1.60	356.00	12	22.00	22.00	20.96	21.46
300	12	455.00	374.00	1.60	406.00	12	26.00	25.00	30.08	30.66
350	14	525.00	438.00	1.60	470.00	12	26.00	29.00	47.08	47.83
375	15	550.00	463.00	1.60	495.00	12	26.00	32.00	62.90	64.31
400	16	580.00	489.00	1.60	521.00	12	26.00	32.00	63.89	64.77
450	18	640.00	552.00	1.60	584.00	16	26.00	35.00	85.12	86.05
500	20	705.00	609.00	1.60	641.00	16	26.00	38.00	112.77	113.91
550	22	735.00	637.00	1.60	673.00	16	30.00	44.00		
600	24	825.00	717.00	1.60	756.00	16	33.00	48.00	194.80	196.27

†Raised face is optional. In regards to iron valves, AS2129 Table D & E are flat face. AS4087 specifies flat face to PN14, whilst PN16 is flat face in iron and raised face in ductile iron.

For iron valve flange dimensions refer to our slide rule [click here](#).

*AS2129 Standard is still in place but is outdated by AS4087 which incorporates PN equivalents but has adopted equivalent flanging and drilling dimensions. However due to the adopting of PN pressure ratings, AS4087 in some cases specifies a larger flange thickness. Refer to last page of this PDF for AS4087. In terms of bolting compatibility between AS4087 and AS2129 flanges, table C, D, PN14 and PN16 are all the same. AS2129 Table E drilling whilst not adopted as part of AS4087, is the same pressure rating as PN14 and the same drilling as AS4087 PN14 and PN16 in all sizes up to 600NB except: 100NB, 250NB & 450NB. Also note that in sizes 50mm, 65mm, 80mm, 350mm, 400mm, 500mm the bolt hole size of the Table E is slightly larger than PN14 & PN16 but the PCD & flange O.D. is the same sizes. AS2129 Table F is the same drilling as AS4087 PN21. AS2129 Table H is the same drilling as AS4087 PN35.

**Flange thickness shown is for Steel plate flanges. For Cast Iron & Ductile Iron flange thickness for integrally flanged valves, etc., refer to our online slide rule [click here](#).

Global Supply Line Pty Ltd ABN 86 008 134 512

Head Office - 1 to 23 Barndioota Rd Salisbury Plain South Australia 5109 Ph +61 (0)8 8285 0000 Fax +61 (0)8 8285 0088 www.globalsupplyline.com.au

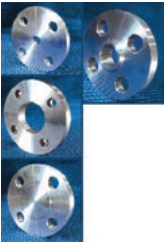

AS 2129* STEEL WELDING NECK FLANGES

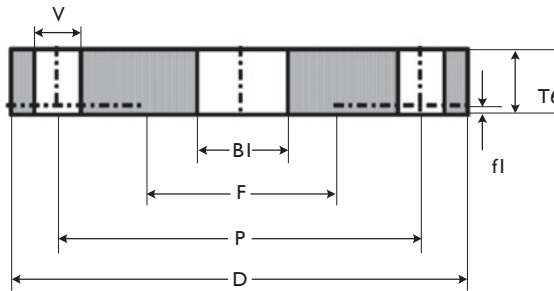

TABLE D DIMENSIONS (mm)

Size		Pipe Outside Diam.	Flange		Raised Face†		Bolting Details			Flange Thickness**	Net Weight	
mm	inch		Inside Diam.	Outside Diam.	Diam.	Thickness	Pitch Circle Diam.	Number of Holes	Diam. of Holes	FF & RF	RF†	FF
mm	inch	mm	B1	D	F	fl	P	N	V	T6	Kg	Kg
15	1/2	21.34	22.30	95.00	47.00	1.60	67.00	4	14.00	12.00	0.18	0.24
20	3/4	26.67	27.60	100.00	53.00	1.60	73.00	4	14.00	12.00	0.20	0.26
25	1	33.40	34.50	115.00	65.00	1.60	83.00	4	14.00	12.00	0.27	0.35
32	1 1/4	42.16	43.10	120.00	67.00	1.60	87.00	4	14.00	12.00	0.34	0.43
40	1 1/2	48.26	49.50	135.00	78.00	1.60	98.00	4	14.00	12.00	0.44	0.55
50	2	60.33	61.90	150.00	90.00	1.60	114.00	4	18.00	12.00	0.73	0.86
65	2 1/2	73.03	74.60	165.00	103.00	1.60	127.00	4	18.00	12.00	0.85	1.00
80	3	88.90	90.60	185.00	122.00	1.60	146.00	4	18.00	12.00	1.35	1.52
100	4	114.30	116.00	215.00	154.00	1.60	178.00	4	18.00	12.00	1.73	1.94
125	5	141.30	143.70	255.00	186.00	1.60	210.00	8	18.00	13.00	3.07	3.35
150	6	168.28	170.60	280.00	211.00	1.60	235.00	8	18.00	13.00	3.86	3.98
175	7			304.80		1.60	260.35	8	18.00		7.98	8.12
200	8	219.08	221.40	335.00	268.00	1.60	292.00	8	18.00	13.00	4.49	4.86
225	9			358.77		1.60	323.85	8	18.00			11.30
250	10	273.05	276.30	405.00	328.00	1.60	356.00	8	22.00	16.00	7.75	8.27
300	12	323.85	327.10	455.00	378.00	1.60	406.00	12	22.00	19.00	10.46	11.04
350	14	355.60	359.10	525.00	438.00	1.60	470.00	12	26.00	22.00	18.05	18.79
375	15			550.00	463.00	1.60	495.00	12	26.00	22.00		43.01
400	16	406.40	410.40	580.00	489.00	1.60	521.00	12	26.00	22.00	20.80	21.68
450	18	457.20	461.70	640.00	532.00	1.60	584.00	12	26.00	25.00	27.86	29.03
500	20	508.00	513.00	705.00	609.00	1.60	641.00	16	26.00	29.00	38.74	39.88
550	22			760.00	637.00	1.60	699.00	16	30.00	29.00	118.97	119.30
600	24	609.60	615.90	825.00	720.00	1.60	756.00	16	30.00	32.00	55.14	56.60

TABLE E DIMENSIONS (mm)

Size		Pipe Outside Diam.	Flange		Raised Face†		Bolting Details			Flange Thickness**	Net Weight	
mm	inch		Inside Diam.	Outside Diam.	Diam.	Thickness	Pitch Circle Diam.	Number of Holes	Diam. of Holes	FF & RF	RF†	FF
mm	inch	mm	B1	D	F	fl	P	N	V	T6	Kg	Kg
15	1/2	21.34	22.30	95.00	47.00	1.60	67.00	4	14.00	12.00	0.23	0.29
20	3/4	26.67	27.60	100.00	53.00	1.60	73.00	4	14.00	12.00	0.25	0.31
25	1	33.40	34.50	115.00	65.00	1.60	83.00	4	14.00	12.00	0.40	0.49
32	1 1/4	42.16	43.10	120.00	67.00	1.60	87.00	4	14.00	12.00	0.49	0.58
40	1 1/2	48.26	49.50	135.00	78.00	1.60	98.00	4	14.00	12.00	0.72	0.83
50	2	60.33	61.90	150.00	90.00	1.60	114.00	4	18.00	12.00	0.94	1.07
65	2 1/2	73.03	74.60	165.00	103.00	1.60	127.00	4	18.00	12.00	1.10	1.26
80	3	88.90	90.60	185.00	122.00	1.60	146.00	4	18.00	12.00	1.50	1.68
100	4	114.30	116.00	215.00	154.00	1.60	178.00	4	18.00	13.00	2.22	2.42
125	5	141.30	143.70	255.00	186.00	1.60	210.00	8	18.00	14.00	3.33	3.61
150	6	168.28	170.60	280.00	211.00	1.60	235.00	8	22.00	17.00	4.45	4.76
175	7			304.80		1.60	260.35	8	18.00			
200	8	219.08	221.40	335.00	268.00	1.60	292.00	8	22.00	19.00	6.57	6.95
225	9			358.17		1.60	323.85	12	22.00	20.63		
250	10	273.05	276.30	405.00	328.00	1.60	356.00	12	22.00	22.00	10.61	11.11
300	12	323.85	327.10	455.00	378.00	1.60	406.00	12	26.00	25.00	13.59	14.17
350	14	355.60	359.10	525.00	438.00	1.60	470.00	12	26.00	29.00	24.03	24.77
375	15			550.00	463.00	1.60	495.00	12	26.00	32.00		
400	16	406.40	410.40	580.00	489.00	1.60	521.00	12	26.00	32.00	30.66	31.54
450	18	457.20	461.70	640.00	532.00	1.60	584.00	12	26.00	35.00	39.13	40.05
500	20	508.00	513.00	705.00	609.00	1.60	641.00	16	26.00	38.00	51.12	52.25
550	22			735.00	637.00	1.60	673.00	16	30.00	44.00		
600	24	609.60	615.90	825.00	720.00	1.60	756.00	16	33.00	48.00	82.54	84.04

†Raised face is optional. In regards to iron valves, AS2129 Table D & E are flat face. AS4087 specifies flat face to PN14, whilst PN16 is flat face in iron and raised face in ductile iron. For iron valve flange dimensions refer to our slide rule [click here](#).

*AS2129 Standard is still in place but is outdated by AS4087 which incorporates PN equivalents but has adopted equivalent flanging and drilling dimensions. However due to the adopting of PN pressure ratings, AS4087 in some cases specifies a larger flange thickness. Refer to last page of this PDF for AS4087. In terms of bolting compatibility between AS4087 and AS2129 flanges, table C, D, PN14 and PN16 are all the same. AS2129 Table E drilling whilst not adopted as part of AS4087, is the same pressure rating as PN14 and the same drilling as AS4087 PN14 and PN16 in all sizes up to 600NB except: 100NB, 250NB & 450NB. Also note that in sizes 50mm, 65mm, 80mm, 350mm, 400mm, 500mm the bolt hole size of the Table E is slightly larger than PN14 & PN16 but the PCD & flange O.D. is the same sizes. AS2129 Table F is the same drilling as AS4087 PN21. AS2129 Table H is the same drilling as AS4087 PN35.

**Flange thickness shown is for Steel plate flanges. For Cast Iron & Ductile Iron flange thickness for integrally flanged valves, etc., refer to our online slide rule [click here](#).

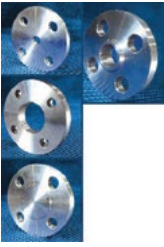

AS 2129* STEEL WELDING NECK FLANGES

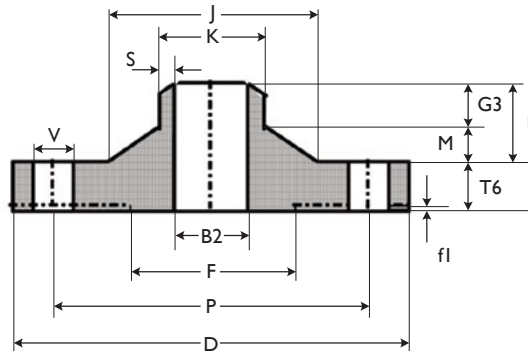

TABLE D DIMENSIONS (mm)

Size	Pipe Outside Diam.	Flange		Raised Face†		Bolting Details			Dimensions of Welding Neck					Flange Thickness**			Net Weight		
		Outside Diam.	Inside Diam.	Diam.	Thickness	Pitch Circle Diam.	No. of Holes	Diam. of Holes	Diam. at large end	Diam. at small end	Total length of Neck	Length of Taper	Height	Thickness	FF & RF	Height	RF†	FF	
mm	inch	mm	D	B2	F	fl	P	N	V	J	K	L	M	L-M	S	T6	L+T6	Kg	Kg
15	1/2	21.35	95.00	15.74	47.00	1.60	67.00	4	14.00	27.00	22.00	22.00	16.00	6.00	2.80	12.00	27.00	0.23	0.29
20	3/4	26.67	100.00	20.87	53.00	1.60	73.00	4	14.00	33.00	27.00	22.00	16.00	6.00	2.90	12.00	27.00	0.26	0.33
25	1	33.40	115.00	26.60	65.00	1.60	83.00	4	14.00	43.00	34.00	22.00	16.00	6.00	3.40	12.00	27.00	0.37	0.46
32	1 1/4	42.16	120.00	34.96	67.00	1.60	87.00	4	14.00	49.00	43.00	25.00	16.00	9.00	3.60	12.00	31.00	0.49	0.58
40	1 1/2	48.26	135.00	40.86	78.00	1.60	98.00	4	14.00	59.00	49.00	29.00	19.00	10.00	3.70	12.00	35.00	0.65	0.78
50	2	60.33	150.00	52.53	90.00	1.60	114.00	4	18.00	70.00	61.00	29.00	19.00	10.00	3.90	12.00	37.00	1.02	1.15
65	2 1/2	73.03	165.00	62.63	103.00	1.60	127.00	4	18.00	83.00	76.00	32.00	22.00	10.00	5.20	12.00	40.00	1.37	1.53
80	3	88.90	185.00	77.90	122.00	1.60	146.00	4	18.00	102.00	89.00	35.00	25.00	10.00	5.50	12.00	45.00	2.06	2.24
100	4	114.30	215.00	102.30	154.00	1.60	178.00	4	18.00	130.00	115.00	41.00	32.00	9.00	6.00	12.00	51.00	2.97	3.18
125	5	141.30	255.00	128.10	186.00	1.60	210.00	8	18.00	152.00	142.00	44.00	32.00	12.00	6.60	13.00	57.00	4.72	4.99
150	6	168.28	280.00	154.08	211.00	1.60	235.00	8	18.00	184.00	169.00	48.00	32.00	16.00	7.10	13.00	61.00	5.81	6.11
200	8	219.08	335.00	202.68	268.00	1.60	292.00	8	18.00	241.00	220.00	51.00	35.00	16.00	8.20	13.00	64.00	8.45	8.83
250	10	273.05	405.00	254.45	328.00	1.60	356.00	8	22.00	292.00	274.00	64.00	44.00	20.00	9.30	16.00	80.00	14.34	14.86
300	12	323.85	455.00	304.85	378.00	1.60	406.00	12	22.00	343.00	324.00	70.00	51.00	19.00	9.50	19.00	89.00	19.28	19.86
350	14	355.60	525.00	336.60	438.00	1.60	470.00	12	26.00	387.00	356.00	73.00	54.00	19.00	9.50	22.00	95.00	30.00	30.75

TABLE E DIMENSIONS (mm)

Size	Pipe Outside Diam.	Flange		Raised Face†		Bolting Details			Dimensions of Welding Neck					Flange Thickness**			Net Weight	
		Outside Diam.	Inside Diam.	Diam.	Thickness	Pitch Circle Diam.	No. of Holes	Diam. of Holes	Diam. at large end	Diam. at small end	Total length of Neck	Length of Taper	Height	Thickness	FF & RF	Height	RF†	
mm	inch	mm	D	B2	F	fl	P	N	V	J	K	L	M	L-M	S	T6	L+T6	Kg
15	1/2	21.34	95.00	15.74	47.00	1.60	67.00	4	14.00	27.00	22.00	22.00	16.00	6.00	2.80	12.00	28.00	0.28
20	3/4	26.67	100.00	20.87	53.00	1.60	73.00	4	14.00	33.00	27.00	22.00	16.00	6.00	2.90	12.00	28.00	0.32
25	1	33.40	115.00	26.60	65.00	1.60	83.00	4	14.00	43.00	34.00	22.00	16.00	6.00	3.40	12.00	29.00	0.52
32	1 1/4	42.16	120.00	34.96	67.00	1.60	87.00	4	14.00	49.00	43.00	25.00	16.00	9.00	3.60	12.00	33.00	0.64
40	1 1/2	48.26	135.00	40.86	78.00	1.60	98.00	4	14.00	59.00	49.00	29.00	19.00	10.00	3.70	12.00	38.00	0.96
50	2	60.33	150.00	52.53	90.00	1.60	114.00	4	18.00	70.00	61.00	29.00	19.00	10.00	3.90	12.00	39.00	1.25
65	2 1/2	73.03	165.00	62.63	103.00	1.60	127.00	4	18.00	83.00	76.00	32.00	22.00	10.00	5.20	12.00	42.00	1.65
80	3	88.90	185.00	77.90	122.00	1.60	146.00	4	18.00	102.00	89.00	35.00	25.00	10.00	5.50	12.00	46.00	2.23
100	4	114.30	215.00	102.30	154.00	1.60	178.00	8	18.00	103.00	115.00	41.00	32.00	9.00	6.00	13.00	54.00	3.51
125	5	141.30	255.00	128.10	186.00	1.60	210.00	8	18.00	152.00	142.00	44.00	32.00	12.00	6.60	14.00	58.00	5.00
150	6	168.28	280.00	154.08	207.00	1.60	235.00	8	22.00	184.00	169.00	48.00	32.00	16.00	7.10	17.00	65.00	6.95
200	8	219.08	335.00	202.68	264.00	1.60	292.00	8	22.00	241.00	220.00	51.00	35.00	16.00	8.20	19.00	70.00	10.83
250	10	273.05	405.00	254.45	328.00	1.60	356.00	12	22.00	292.00	274.00	64.00	44.00	20.00	9.30	22.00	86.00	17.62
300	12	323.85	455.00	304.85	374.00	1.60	406.00	12	26.00	343.00	324.00	70.00	51.00	19.00	9.50	25.00	95.00	22.92
350	14	355.60	525.00	336.60	438.00	1.60	470.00	12	26.00	387.00	356.00	73.00	54.00	19.00	9.50	29.00	102.00	36.65

†Raised face is optional. In regards to iron valves, AS2129 Table D & E are flat face. AS4087 specifies flat face to PN14, whilst PN16 is flat face in iron and raised face in ductile iron. For iron valve flange dimensions refer to our slide rule click [here](#).

*AS2129 Standard is still in place but is outdated by AS4087 which incorporates PN equivalents but has adopted equivalent flanging and drilling dimensions. However due to the adopting of PN pressure ratings. AS4087 in some cases specifies a larger flange thickness. Refer to last page of this PDF for AS4087. In terms of bolting compatibility between AS4087 and AS2129 flanges, table C, D, PN14 and PN16 are all the same. AS2129 Table E drilling whilst not adopted as part of AS4087, is the same pressure rating as PN14 and the same drilling as AS4087 PN14 and PN16 in all sizes up to 600NB except: 100NB, 250NB & 450NB. Also note that in sizes 50mm, 65mm, 80mm, 350mm, 400mm, 500mm the bolt hole size of the Table E is slightly larger than PN14 & PN16 but the PCD & flange O.D. is the same sizes. AS2129 Table F is the same drilling as AS4087 PN21. AS2129 Table H is the same drilling as AS4087 PN35.

**Flange thickness shown is for Steel plate flanges. For Cast Iron & Ductile Iron flange thickness for integrally flanged valves, etc., refer to our online slide rule click [here](#).



AS4087 STEEL FLANGES PN16/21/35

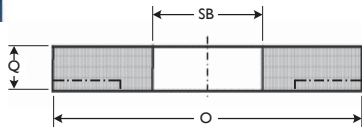
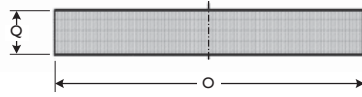
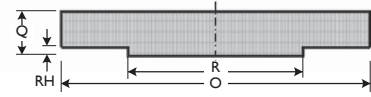

Plate Slip-On Welding



Blind



Can be supplied with raised face (Non Standard)

PN16 DIMENSIONS (mm)

Nominal Pipe Size	Slip on Bore	Range Outside Diameter	RF Height	RF Diameter	Thickness**	Bolt Circle Diameter	Number of Holes	Hole Diameter
mm	SB	O	RH	R	Q	P	N	HD
50	62	150	3	90	11	114	4	18
65	75	165	3	103	11	127	4	18
80	91	185	3	122	11	146	4	18
100	116	215	3	154	13	178	4	18
150	171	280	3	211	13	235	8	18
165	168	280	3	211	13	235	8	18
200	221	335	3	268	19	292	8	18
225		370	3	300	19	324	8	18
250	276	405	3	328	19	356	8	22
300	327	455	4	378	23	406	12	22
350	359	525	4	438	30	470	12	26
375		550	4	463	30	495	12	26
400	409	580	4	489	30	521	12	26
450	460	640	4	552	30	584	12	26
500	511	705	4	609	38	641	16	26
600	613	825	5	720	48	756	16	30
700	715	910	5	809	56	845	20	30
750	765	995	5	888	56	927	20	33
800	816	1060	5	942	56	984	20	36
900	918	1175	5	1050	66	1092	24	36
1000	1020	1255	5	1133	66	1175	24	36
1200	1224	1490	5	1368	76	1410	32	36

For PN14 drilling & O.D. of flange is the same as PN16

PN21 DIMENSIONS (mm)

Nominal Pipe Size	Slip on Bore	Range Outside Diameter	RF Height	RF Diameter	Thickness**	Bolt Circle Diameter	Number of Holes	Hole Diameter
mm	SB	O	RH	R	Q	P	N	HD
50	62	165	3	103	15	127	4	18
65	75	185	3	122	15	146	8	18
80	91	205	3	141	15	165	8	18
100	116	230	3	167	19	191	8	18
150	171	305	3	232	24	260	12	22
165	168	305	3	232	24	260	12	22
200	221	370	3	296	24	324	12	22
225		405	3	324	30	356	12	26
250	276	430	3	349	30	381	12	26
300	327	490	4	406	30	438	16	26
350	359	550	4	459	30	495	16	30
375		580	4	485	38	521	16	30
400	409	610	4	516	38	552	20	30
450	460	675	4	571	38	610	20	33
500	511	735	4	634	48	673	24	33
600	613	850	5	739	58	781	24	36
700	715	935	5	815	58	857	24	36
750	765	1015	5	898	58	940	28	36
800	816	1060	5	942	68	984	28	36
900	918	1185	5	1060	68	1105	32	39
1000	1020	1275	5	1149	78	1194	36	39
1200	1224	1530	5	1385	88	1441	40	42

PN35 DIMENSIONS (mm)

Nominal Pipe Size	Slip on Bore	Range Outside Diameter	RF Height	RF Diameter	Thickness**	Bolt Circle Diameter	Number of Holes	Hole Diameter
mm	SB	O	RH	R	Q	P	N	HD
50	62	165	3	103	19	127	4	18
65	75	185	3	122	19	146	8	18
80	91	205	3	141	24	165	8	18
100	116	230	3	167	24	191	8	18
150	171	305	3	232	31	260	12	22
165	168	305	3	232	31	260	12	22
200	221	370	3	260	31	324	12	22
225		405	3	286	38	356	12	26
250	276	430	3	311	38	381	12	26
300	327	490	4	362	38	438	16	26
350	359	550	4	419	48	495	16	30
375		580	4	445	48	521	16	30
400	409	610	4	483	48	552	20	30
450	460	675	4	533	58	610	20	33
500	511	735	4	597	58	673	24	33
600	613	850	5	699	68	781	24	36
700	715	935	5	800	78	857	24	36
750	765	1015	5	898	78	940	28	36
800	816	1060	5	935	84	984	28	36
900	918	1185	5	1030	94	1105	32	39
1000	1020	1275	5	1149	98	1194	36	39
1200	1224	1530	5	1385	108	1441	40	42

As a general guide, AS4087 PN14, PN16 is the same dimensions and drilling as AS2129 Table D. AS4087 PN21 is the same dimensions, drilling and pressure rating as AS2129 Table F. AS4087 PN35 is the same dimensions, drilling and pressure rating as AS2129 Table H. However very minor flange thickness increases has been made to AS4087 to provide the higher PN pressure rating. For the same reason raised face (where applicable) diameters also vary slightly although RF rarely specified (in the case of cast iron valves PN14 & PN16 is flat faced and ductile iron PN16 is raised face). The standard for AS2129 Table D, E, F H is still use. In terms of bolting compatibility between AS4087 and AS2129 flanges, table C, D, PN14 and PN16 are all the same. Table E drilling whilst not adopted as part of AS4087, is the same pressure rating as PN14 and the same drilling as PN14 and PN16 in all sizes up to 600NB except: 100NB, 250NB & 450NB. AS2129 Table F is the same drilling as AS4087 PN21. AS2129 Table H is the same drilling as AS4087 PN35.

**Flange thickness shown is for Steel. For Cast Iron & Ductile Iron flange thickness for integrally flanged valves, etc., refer to our online slide rule covering AS4087 PN14 to PN35 and all other flanges click [here](#). PN16 valves are flat face in cast iron and raised face in ductile iron.